

**Morehead First Christian Church Board Minutes
January 22, 2001**

President Al Evans called the meeting to order on January 22, 2001 at 7:35 p.m. Rev. Robert Franz opened the meeting with prayer. Attending the meeting were: Dianna Reynolds, Scharline Whidden, Neva and Tommy Griffith, Ron and Natalie Caudill, Chloetean Calvert, Betty L. Hall, Fran Helphinstine, Alta and Don Blair, Bob Franz, David Perkins, Glen and Anne Buckner, Larry Fannin, Ron Walke, Marge and Dan Thomas, Eva and Glenn Johnston and Linda Bryant.

The minutes from the previous meeting were approved. A motion was made by Fran Helphinstine, and seconded by Alta Blair.

The treasurer's report was approved after a motion from Ron Walke and a second by Fran Helphinstine. The Board adopted a resolution to establish a housing fund for the minister of \$650.00 per month. The Board approved an accountable expense account for the minister of \$1,000 with a motion from David Perkins and a second by Glenn Johnston.

The following committee reports were given:

CWF: Neva Griffith reported that a CWF planning session would be held next Monday.

DEACONS: List not available for meeting.

ELDERS: Tommy Griffith stated that the Elders had not met.

EVANGELISM/MEMBERSHIP: Chair, Anne Buckner reported that a meeting was held on Sunday, January 21, in which plans for the year were discussed by committee members.

LIVING MEMORIAL: David Perkins reported current book value for LMF as of 12/30/2000 is \$330,733.92. Third quarter amount of \$27,532.02 is available from LMF and \$7,783.38 available from IFH.

PERSONNEL: A motion made by Al Evans and seconded by Linda Bryant that the church give Kristi Davis, church nursery attendant a wedding gift of \$100. Motion approved.

STEWARDSHIP: Ron Walke reported that \$94,000 has been pledged as of this date.

SEARCH/PULPIT: Ron Caudill reported that the committee received thirteen new Ministerial Profiles. Contacts with seven of the ministers have been made. The committee will meet on Tuesday for more discussion and follow-up.

WORLD OUTREACH: Alta Blair reported that Eva Johnston would be presenting the 5th Sunday mission statement in church service.

WORSHIP: Al Evans expressed that Jeanne Huie, Chair thanked all who helped during the Advent season. If you have any thoughts or ideas on worship please talk to Jeanne

VISION MISSION STATEMENT: A Vision Mission Statement was discussed and a motion made by Tommy Griffith and seconded by Fran Helphinstine to table discussion until Dr. Grote could present the document to the Board.

PROPERTY: Tommy Griffith reported improvements made at Faith Annex. In the bathroom, a shower was added, new flooring, vanity, painting and etc. The amount of the project was around \$2,000. He thanked the workers for doing a great job.

MINISTER'S REPORT: Rev. Franz reported that the church outreach for the holiday was very impressive. This was a statement of life and energy found in our church. He thanked the church for the generous gift given to him at Christmas. He was very satisfied with the attendance of the Evangelism/Membership committee. Rev. Franz suggested that a new chair be selected for every committee. Tuesday Bible Study attendance is very good. Prayer list people mentioned were: David Brewster, Grote family, Kay Evans, Candy Caudill, families of Annie Courtney and Colleen McCormick.

NEW BUSINESS: Ron Walke suggested that within the next month that plans for revision of the bylaws should begin taking place.

Proposed budget for 2001 has been accepted.

LANDSCAPING COMMITTEE: Natalie Caudill reported for Kay Evans. Landscaping Reports were handed out. The Committee has approved plans for the landscaping work that will contain a memorial garden with brick courtyard. The landscaping will take place in the front and back yard of Friendly Place, in addition to the patio side of the church. (Report attached to minutes.) A motion was made by Glenn Johnston and seconded by Tommy Griffith to give approval to the committee to begin the landscaping project as proposed.

Anne Buckner closed the meeting with prayer.

FIRST CHRISTIAN CHURCH

BUDGET TO ACTUAL COMPARISON

1-1-2001 to 1-22-2001

		Budgeted 2001	This Month's Income	Income Year to Date	
4000	INCOME:				
4105	Christian Church Homes		\$22.00	\$22.00	
4110	Christmas		\$0.00	\$0.00	
4115	Easter		\$0.00	\$0.00	
4120	Heifer Project		\$0.00	\$0.00	
4125	Operations		\$18,218.70	\$18,218.70	
4130	Pentecost		\$0.00	\$0.00	
4135	Reconciliation		\$0.00	\$0.00	
4140	Thanksgiving		\$0.00	\$0.00	
4145	Week of Compassion		\$0.00	\$0.00	
4150	Special Restricted Gift		\$0.00	\$0.00	
4155	Other Contributions		\$0.00	\$0.00	
4210	Miscellaneous		\$0.00	\$0.00	
4220	Program/Event Fees		\$270.00	\$270.00	
4230	Reimbursed Expenses		\$0.00	\$0.00	
	Total Income		\$18,510.70	\$18,510.70	
		Budgeted 2001	This Month's Expenses	Expenses Year to Date	Variation \$0.00 Under (\$0.00) Over
6000	EXPENSES:				
6100	ADMINISTRATION				
6110	Copier Supplies & Maint.		\$248.15	\$248.15	(\$248.15)
6120	Postage		\$68.00	\$68.00	(\$68.00)
6130	Telephone		\$118.53	\$118.53	(\$118.53)
6140	Office Supplies		\$1.49	\$1.49	(\$1.49)
6150	Miscellaneous		\$114.90	\$114.90	(\$114.90)
	Total Administration	\$0.00	\$551.07	\$551.07	(\$551.07)
6200	Personnel				
6210	Minister		1469.93	1469.93	(\$1,469.93)
6220	Secretary		358.69	358.69	(\$358.69)
6230	Custodian		97.34	97.34	(\$97.34)
6240	Musician				\$0.00
6250	Choir Dir		328.46	328.46	(\$328.46)
6260	Nursery Attendant				\$0.00
6270	Student or Assoc. Minister				\$0.00
6275	Minister's Expenses				\$0.00
6280	Honoraria		\$125.00	\$125.00	(\$125.00)
6285	Employer's SS				\$0.00
6290	Employer's Medicare				\$0.00
6295	Workers Compensation				\$0.00
	Total Personnel	\$0.00	\$2,379.42	\$2,379.42	(\$2,379.42)
6300	PROPERTY				
6310	Maintenance		\$308.14	\$308.14	(\$308.14)
6320	Insurance				\$0.00
6330	Utilities		\$213.42	\$213.42	(\$213.42)

6331	Electricity		200.42	200.42	
6332	Sewer-Water-Gas				
6333	Solid Waste		\$13.00	\$13.00	
	Total Property	\$0.00	\$521.56	\$521.56	(\$521.56)
6400	EDUCATION				
6410	Christian Ed Material		\$10.28	\$10.28	(\$10.28)
6420	Vacation Bible School				\$0.00
6430	Youth Activities				\$0.00
6440	Camp Fees				\$0.00
6450	Gifts - Grads & Teachers				\$0.00
	Total Education	\$0.00	\$10.28	\$10.28	(\$10.28)
6500	EVANGELISM & MEMBERSHIP				
6510	Supplies & Expenses				\$0.00
	Total Membership	\$0.00	\$0.00	\$0.00	\$0.00
6600	OUTREACH				
6610	Pledge - BMF				\$0.00
6620	Special Offerings		\$307.00	\$307.00	(\$307.00)
6630	Christian Church Homes				\$0.00
6640	Heifer Project				\$0.00
6650	KY Council of Churches				\$0.00
6660	Local Outreach				\$0.00
6670	Human Concerns Funding				\$0.00
	Total Outreach	\$0.00	\$307.00	\$307.00	(\$307.00)
6700	STEWARDSHIP				
6710	Supplies & Expenses				\$0.00
	Total Stewardship	\$0.00	\$0.00	\$0.00	\$0.00
6800	WORSHIP				
6810	Bell Maintenance		\$8.39	\$8.39	(\$8.39)
6820	Candles & Flowers				\$0.00
6830	Choral Supplies		\$7.88	\$7.88	(\$7.88)
6840	Communion Supplies				\$0.00
6850	Organ Maintenance				\$0.00
6860	Piano Maintenance				\$0.00
6870	Printed Material				\$0.00
6880	Seasonal Decorations		\$50.00	\$50.00	(\$50.00)
6890	Miscellaneous				\$0.00
6895	Guest Musicians				\$0.00
	Total Worship	\$0.00	\$66.27	\$66.27	(\$66.27)
	Subtotal Expenses		\$3,835.60	\$3,835.60	
7000	Non budgeted Expenses				
7100	Program/Event Expense		\$500.00	\$500.00	(\$500.00)
7300	Capital Expenditures		\$1,655.70	\$1,655.70	(\$1,655.70)
7500	Uncategorized Expenses				\$0.00
	Total Non-Budgeted	\$0.00	\$2,155.70	\$2,155.70	(\$2,155.70)
	TOTAL EXPENSES	\$0.00	\$5,991.30	\$5,991.30	
	NET INCOME(LOSS)		\$12,519.40	\$12,519.40	
	Bank Balance		01/01/2001	\$6,495.32	
	Bank Balance		01/22/2001	\$19,014.72	

Morehead First Christian Church
Executive Board Meeting
February 26, 2001

The following items were discussed at the February Executive Board Meeting:

- The resignation of Myron Doan as a Deacon.
- The vacation request from Nora Mullins, Secretary.
- The sick leave policy for the secretary.
- Although the practice should be limited, Deacons are allowed to serve consecutive terms.
- The Sipleys and Caldwells would sing on March 18th. An honorarium would be provided for the Sipleys.
- The new chair for the Worship Committee would be Bob Bradley.
- The new chair for the Outreach Committee would be Donna Corley.
- There will be a dinner for the firemen on March 25th and another for the policemen on April 29th.
- The nominating committee and who serves on that committee was discussed.

**Morehead First Christian Church Board Minutes
February 26, 2001**

President Al Evans called the meeting to order on February 26, 2001 at 7:30. Rev. Robert Franz opened the meeting with prayer. Attending the meeting were Al Evans, David Perkins, Ron and Natalie Caudill, Glen and Anne Buckner, Dan and Marge Thomas, Dianna Reynolds, Betty Hall, Linda Bryant, Scharline Whidden, , Jeanne and Bill Huie, Wayne and Hedwine Caldwell, Fran Helphinstine, Mickey Reffitt, Joe Macke, Glen and Eva Johnston, Ron and Di Walke, Don Blair , Neva Griffith, Larry Fannin, Shirley Parker and Rev. Franz.

The minutes (with corrections) from the previous meeting were approved after a motion from Fran Helphinstine and a second by Di Walke.

The Treasurer's report was approved after a motion from Fran Helphinstine and a second by Linda Bryant.

CWF: Natalie Caudill reported that monthly CWF meetings were no longer being held. The CWF planning committee consisting of members Mabel Reynolds, Neva Griffith, Linda Bryant and Natalie Caudill met in January to discuss and prepare a project list for 2001. This list and information will appear in the March Echo and the first two Sunday bulletins in March.

ELDERS: Larry Fannin advised that the Elders met and Bob Bradley attended to explain about the Prayer Vigil and the Day of Fasting. The Prayer Vigil will be held for 12 hours on Good Friday. At least 24 people will be needed to cover each half hour time segment. Larry expressed his appreciation to Bob Bradley and Betty Hall for their leadership in the spiritual building of the church. The board was reminded that a bean dinner was to be held on Ash Wednesday starting at 6:30 p.m. Bob Franz would be starting a pastor's class for young people. Each young person would be assigned a Mentor of their choice. The Elders also discussed the hope that better communications would evolve among the flocks.

LIVING MEMORIAL: Shirley Parker reported that we had received gifts in memory of Chlotean Calvert and George O. Jackson (Katherine Caudill's brother).

EVANGELISM: Anne Buckner advised that March 25 would be the day to honor the Morehead Fire Department personnel and their families. There will be a dinner held in fellowship hall after the Sunday Morning Service. April 29th has been the date set aside to honor the Police Department and the Emergency workers and their families.

PERSONNEL: Al Evans advised that Nora had requested April 29 through May 4 as vacation. This request was approved.

PROPERTY: Mickey Reffit had agreed to serve as Interim Property Chairman until the Whiddens take over for the next fiscal year. Discussions on several capital projects were discussed. Larry Fannin moved that \$500 be appropriated to do projects deemed necessary right away. The committee could then come back to the next board meeting with further recommendations. Wayne Caldwell seconded the motion. The Motion was approved.

PULPIT: Ron Caudill advised that the pulpit committee was meeting every Tuesday after Bible Study. Currently three or four resumes were being considered.

OUTREACH: Don Blair reported that the Outreach Committee would be chaired by Donna Corley for the new year. Alta and Don would remain on the committee.

WORSHIP: Jeanne Huie reported that Lenten Season plans were in place. Good Friday services would be held at the Methodist Church. The Sipleys and the Caldwelles would sing at the March 18 church service. College Students would sing at the Palm Sunday service. The choir would perform a Cantata on Easter Sunday.

DEACONS: Deacons scheduled to serve for March are Linda Bryant, Wayne Caldwell, Lee Chaney, Scharline Whidden, Debbi Glass and Connie Hamilton. Myron Doan's resignation as a Deacon was accepted by the Board.

There were no reports from the following committees: Stewardship and Education.

Rev. Franz expressed his appreciation for the work of the various committees. He felt that many items were lifted up at the retreat held in early February. He noted that there was a nice turnout for the board meeting.

In new business, Marge Thomas reported the Bosnian family sponsored by the church seven years ago had become United States Citizens. She asked that payment of flowers sent to the ceremony be approved. Fran Helphinstine made this motion and it was seconded by Di Walke. Motion was approved.

Al Evans asked that the standing nominating committee be convened for nominations for the new year. The members from last year are Linda Bryant, Shirley Parker, Larry Fannin, Fran Helphinstine, Scharline Whidden and Donna Corley. Two members will go off per the by-laws and two new members will be selected. The nominating committee will recommend new Deacons, Committee Chairs and Executive Board. Di Walke moved that the meeting be adjourned. Wayne Caldwell closed the meeting with prayer.

FIRST CHRISTIAN CHURCH

BUDGET TO ACTUAL COMPARISON

		1/23/01	To	2/26/01	
		Budgeted 2001	This Month's Income	Income Year to Date	
4000	INCOME:				
4105	Christian Church Homes			22.00	
4110	Christmas				
4115	Easter				
4120	Heifer Project		228.00	228.00	
4125	Operations	139,090.00	8,913.49	27,132.19	111,957.81
4130	Pentecost				
4135	Reconciliation				
4140	Thanksgiving				
4145	Week of Compassion		637.00	637.00	
4150	Special Restricted Gift				
4155	Other Contributions				
4210	Miscellaneous				
4220	Program/Event Fees		135.00	405.00	
4230	Reimbursed Expenses				
	Total Income	139,090.00	9,913.49	28,424.19	
		Budgeted 2001	This Month's Expenses	Expenses Year to Date	Variation \$0.00 Under (\$0.00) Over
6000	EXPENSES:				
6100	ADMINISTRATION				
6110	Copier Supplies & Maint.	2,500.00		248.15	2,251.85
6120	Postage	1,000.00	142.85	210.85	789.15
6130	Telephone	1,500.00	134.49	253.02	1,246.98
6140	Office Supplies	2,200.00	60.32	61.81	2,138.19
6150	Miscellaneous	600.00	125.90	240.80	359.20
	Total Administration	7,800.00	463.56	1,014.63	6,785.37
6200	Personnel				
6210	Minister	51,962.00	5,396.16	6,866.09	45,095.91
6215	Pulpit Committee	5,000.00			
6220	Secretary	12,000.00	1,519.65	1,878.34	10,121.66
6230	Custodian	2,600.00	325.18	422.52	2,177.48
6240	Musician	3,780.00	606.65	606.65	3,173.35
6250	Choir Dir	3,780.00	606.65	935.11	2,844.89
6260	Nursery Attendant	1,040.00	156.00	156.00	884.00
6270	Student or Assoc. Minister	7,800.00			7,800.00
6275	Minister's Expenses	1,000.00			1,000.00
6280	Honoraria	300.00		125.00	175.00
6285	Employer's SS	1,948.00	238.92	238.92	1,709.08
6290	Employer's Medicare	455.00	55.88	55.88	399.12
6295	Workers Compensation	1,350.00	518.84	518.84	831.16
	Total Personnel	93,015.00	9,423.93	11,803.35	76,211.65
6300	PROPERTY				
6310	Maintenance	10,000.00	37.03	345.17	9,654.83
6320	Insurance	3,600.00			3,600.00

6330	Utilities	10,000.00	1,676.22	1,889.64	8,110.36
6331	Electricity		215.01	415.43	
6332	Sewer-Water-Gas		1,448.21	1,448.21	
6333	Solid Waste		13.00	26.00	
	Total Property	23,600.00	1,713.25	2,234.81	21,365.19
6400	EDUCATION				
6410	Christian Ed Material	600.00		10.28	589.72
6420	Vacation Bible School	150.00	214.00	214.00	(64.00)
6430	Youth Activities	500.00			500.00
6440	Camp Fees	500.00			500.00
6450	Gifts - Grads & Teachers	125.00			125.00
	Total Education	1,875.00	214.00	224.28	1,650.72
6500	EVANGELISM & MEMBERSHIP				
6510	Supplies & Expenses	800.00	147.65	147.65	652.35
	Total Membership	800.00	147.65	147.65	652.35
6600	OUTREACH				
6610	Pledge - BMF	6,000.00	2,000.00	2,000.00	4,000.00
6620	Special Offerings		637.00	637.00	(637.00)
6630	Christian Church Homes			307.00	(307.00)
6640	Heifer Project		228.00	228.00	(228.00)
6650	KY Council of Churches	100.00			100.00
6660	Local Outreach				-
6670	Human Concerns Funding	500.00			500.00
	Total Outreach	6,600.00	2,865.00	3,172.00	3,428.00
6700	STEWARDSHIP				
6710	Supplies & Expenses	200.00			-
	Total Stewardship	200.00	-	-	-
6800	WORSHIP				
6810	Bell Maintenance	150.00			150.00
6820	Candies & Flowers	600.00		8.39	591.61
6830	Choral Supplies	750.00			750.00
6840	Communion Supplies	450.00		7.88	442.12
6850	Organ Maintenance	1,200.00			1,200.00
6860	Piano Maintenance	200.00			200.00
6870	Printed Material	900.00	30.74	30.74	869.26
6880	Seasonal Decorations	250.00		50.00	200.00
6890	Miscellaneous	300.00			300.00
6895	Guest Musicians	400.00			400.00
	Total Worship	5,200.00	30.74	97.01	4,702.99
	Subtotal Expenses		14,858.13	18,693.73	
7000	Non budgeted Expenses				
7100	Program/Event Expense		(71.00)	429.00	(429.00)
7300	Capital Expenditures			1,655.70	(1,655.70)
7500	Uncategorized Expenses				-
	Total Non-Budgeted	-	(71.00)	2,084.70	(2,084.70)
	TOTAL EXPENSES	139,090.00	14,787.13	20,778.43	
	NET INCOME(LOSS)		(4,873.64)	7,645.76	
	Bank Balance		1/1/01	6,495.32	
	Bank Balance		2/26/01	\$14,141.08	

Morehead First Christian Church
Monthly Board Meeting
March 26, 2001

- | | |
|------------------------------|--------------------------|
| 1. CALL TO ORDER | Al Evans, President |
| 2. OPENING PRAYER | |
| 3. PREVIOUS MEETINGS MINUTES | |
| 4. TREASURER'S REPORT | David Perkins, Treasurer |
| 5. COMMITTEE REPORTS: | |
| CWF | Mabel Reynolds |
| DEACONS | Natalie Caudill |
| | Sarah Chaney |
| EDUCATION | |
| ELDERS | Tommy Griffith |
| | Larry Fannin |
| EVANGELISM | |
| LIVING MEMORIAL | Shirley Parker |
| PERSONNEL | Al Evans |
| | |
| STEWARDSHIP | Ron Cauldwell |
| WORLD OUTREACH | Don & Alta Blair |
| WORSHIP | Jeanne Huie |
| PROJECT 2000 | Nelson Grote |
| PROPERTY | |
| 6. MINISTER'S REPORT | |
| 7. OLD BUSINESS | |
| 8. NEW BUSINESS | |
| 9. CLOSING PRAYER | |

Morehead First Christian Church Board Minutes
April 23, 2001

President Al Evans called the meeting to order on April 23, 2001 at 7:30 p.m. Larry Fannin opened the meeting with prayer. Attending the meeting were Ron and Natalie Caudill, Dianna and Ron Walke, Hedy and Wayne Caldwell, Jeanne Huie, Linda Bryant, Scharline Whidden, Anne Buckner, Al Evans, Connie Hamilton, Neva and Tommy Griffith, David Perkins, Larry Fannin, Mickey Reffit, Shirley Parker and Rev. Bob Franz.

The Board approved the minutes from the last meeting following a motion from Wayne Caldwell and a second by Linda Bryant.

The Board approved the Treasurer's report following a motion from Ron Walke and a second by Jeanne Huie.

The following committee reports were given:

CWF: Natalie Caudill reported that many women had volunteered for the CWF projects, but still more volunteers were needed and there would be a telethon recruitment program to obtain more volunteers. Mabel Reynolds, Dianna Walke and Kathy Williams attended the CWF meeting in Lexington. Neva Griffith will be collecting money for the flowers for Fathers' Day and Mothers' Day. The quarterly meeting of the CWF group would be held on June 24th at 4 p.m. at the home of Marge Thomas.

DEACONS: Deacons scheduled to serve in May are Wayne Caldwell, Jeanne Huie, Bill Huie, Dianna Reynolds, Dan Thomas and Scharline Whidden.

ELDERS: Tommy Griffith advised that the Elders had not met since the last Board Meeting. Larry Fannin expressed his gratitude to Rev. Franz for his leadership in making the Advent season a great spiritual experience.

EVANGELISM: Anne Buckner advised that on Sunday we would have the appreciation dinner for the City Police and other workers. She asked that each one of us try to double our recipes so that we would have plenty of food.

LIVING MEMORIAL: Shirley Parker reported that numerous gifts were given in memory of Helen Patrick. David Perkins shared the quarterly report of the Living Memorial Fund. The Fund generated \$4788 income for the first quarter of 2001. The Living Memorial has \$31,194 in unspent income and the Inez Faith Humphrey has \$9210 in unspent income.

WORSHIP: Jeanne Huie expressed her appreciation for the Choir's Easter program. An appreciation dinner was held last night for the choir. The lilies purchased for Easter were ready to be taken home. Those that were not taken home would be planted in the churchyard. Jeanne reported that many people had requested that the Penix Room be made into a prayer room. Tommy Griffith recommended that the Penix Room be

temporarily used as prayer room and if usage of the room was frequent, we could then make plans to permanently make the room a prayer room.

PROPERTY: Mickey Reffit advised that the lawn needed to be mowed. The Board decided that a lawn service should be obtained to care for the lawn this summer.

PULPIT: Ron Caudill reported that Rev. John Dunstan would be with us on Sunday morning, April 29th. Rev. Franz would do the framework of the service and Rev. Dunstan would deliver the sermon.

NOMINATING: The committee chaired by Wayne Caldwell presented the following slate of Officers and Deacons as nominations to be voted on at the annual congregation meeting on May 6, 2001:

President - Al Evans
Vice President - Wayne Caldwell
Secretary - Shirley Parker
Treasurer - David Perkins

Assistant Treasurers - Shirley Parker, Glenn Johnston, Ron Walke, Wayne Caldwell
Deacons - Jim Fred Cassity, William Davis, Sr. Margaret Davis, Mickey Reffit, Elizabeth Reffitt, Donna Corley and Pat Adkins. Ron Caudill and Connie Hamilton would fill two unexpired terms.

No reports were received from Education, Personnel, Stewardship, World Outreach, and Project 2000.

Mr. Proctor Caudill delivered a check for \$150,000 from the estate of Louise Caudill. According to the Caudill will: "A gift of \$150,000 shall be given to the First Christian Church of Morehead. This money, I would like to be used for the advancement of the church in Morehead." After a lengthy discussion, the Board decided that this gift should be a part of the Inez Faith Humphrey Fund on a motion by Tommy Griffith and a second by Mickey Reffit. Mickey Reffit moved that \$100,000 be transferred to Peoples Bank of Sandy Hook (Morehead Branch). This motion was seconded by Ron Walke and passed by the Board. The remaining \$50,000 would be invested with the Christian Church Fund.

Rev. Franz expressed his appreciation for a lovely Easter service. He asked that we all pray for Rev. Dunstan and the church. The church should try in every way to make Rev. Dunstan feel welcome. Rev. Franz' request to have each Wednesday off was also approved. The appropriate salary adjustment would be made.

Al Evans reported that the church phone lines had been hit by lightening and that Nora's husband had been working on the problem. The Echo will be sent out early this month due to Nora Mullins' vacation.

Dianna Walke closed the meeting with prayer.

temporarily used as prayer room and if usage of the room was frequent, we could then make plans to permanently make the room a prayer room.

PROPERTY: Mickey Reffit advised that the lawn needed to be mowed. The Board decided that a lawn service should be obtained to care for the lawn this summer.

PULPIT: Ron Caudill reported that Rev. John Dunstan would be with us on Sunday morning, April 29th. Rev. Franz would do the framework of the service and Rev. Dunstan would deliver the sermon.

NOMINATING: The committee chaired by Wayne Caldwell presented the following slate of Officers and Deacons as nominations to be voted on at the annual congregation meeting on May 6, 2001:

President - Al Evans
Vice President - Wayne Caldwell
Secretary - Shirley Parker
Treasurer - David Perkins

Assistant Treasurers - Shirley Parker, Glenn Johnston, Ron Walke, Wayne Caldwell
Deacons - Jim Fred Cassity, William Davis, Sr. Margaret Davis, Mickey Reffit, Elizabeth Reffitt, Donna Corley and Pat Adkins. Ron Caudill and Connie Hamilton would fill two unexpired terms.

Letters for transfer on 5/10/01

No reports were received from Education, Personnel, Stewardship, World Outreach, and Project 2000.

Mr. Proctor Caudill delivered a check for \$150,000 from the estate of Louise Caudill. According to the Caudill will: "A gift of \$150,000 shall be given to the First Christian Church of Morehead. This money, I would like to be used for the advancement of the church in Morehead." After a lengthy discussion, the Board decided that this gift should be a part of the Inez Faith Humphrey Fund on a motion by Tommy Griffith and a second by Mickey Reffit. Mickey Reffit moved that \$100,000 be transferred to Peoples Bank of Sandy Hook (Morehead Branch). This motion was seconded by Ron Walke and passed by the Board. The remaining \$50,000 would be invested with the Christian Church Fund.

Rev. Franz expressed his appreciation for a lovely Easter service. He asked that we all pray for Rev. Dunstan and the church. The church should try in every way to make Rev. Dunstan feel welcome. Rev. Franz' request to have each Wednesday off was also approved. The appropriate salary adjustment would be made.

Al Evans reported that the church phone lines had been hit by lightening and that Nora's husband had been working on the problem. The Echo will be sent out early this month due to Nora Mullins' vacation.

Dianna Walke closed the meeting with prayer.

**Morehead First Christian Church Executive Board Minutes
April 23, 2001**

President Al Evans opened the meeting with the news that Proc Caudill would be attending the regular Board meeting and deliver a check from the estate of Louise Caudill.

Other items discussed at the executive board meeting:

- There would be a guest minister on May 6, 2001. Rev. Franz would be attending his son's college graduation.
- A dinner would be held on April 29, 2001 honoring the Emergency workers and Morehead City Policemen.
- David Perkins informed us that the Living Memorial Fund had sustained a 4½ % loss in market value over the first quarter 2001.
- Rev. Franz asked that he would like to have Wednesdays off and that his compensation be adjusted accordingly.

Those attending the meeting were Anne Buckner, Jeanne Huie, Tommy Griffith, Al Evans, Wayne Caldwell, David Perkins, and Shirley Parker.

Landscape Committee
Spring 2001

Memorial Garden
with Brick Courtyard

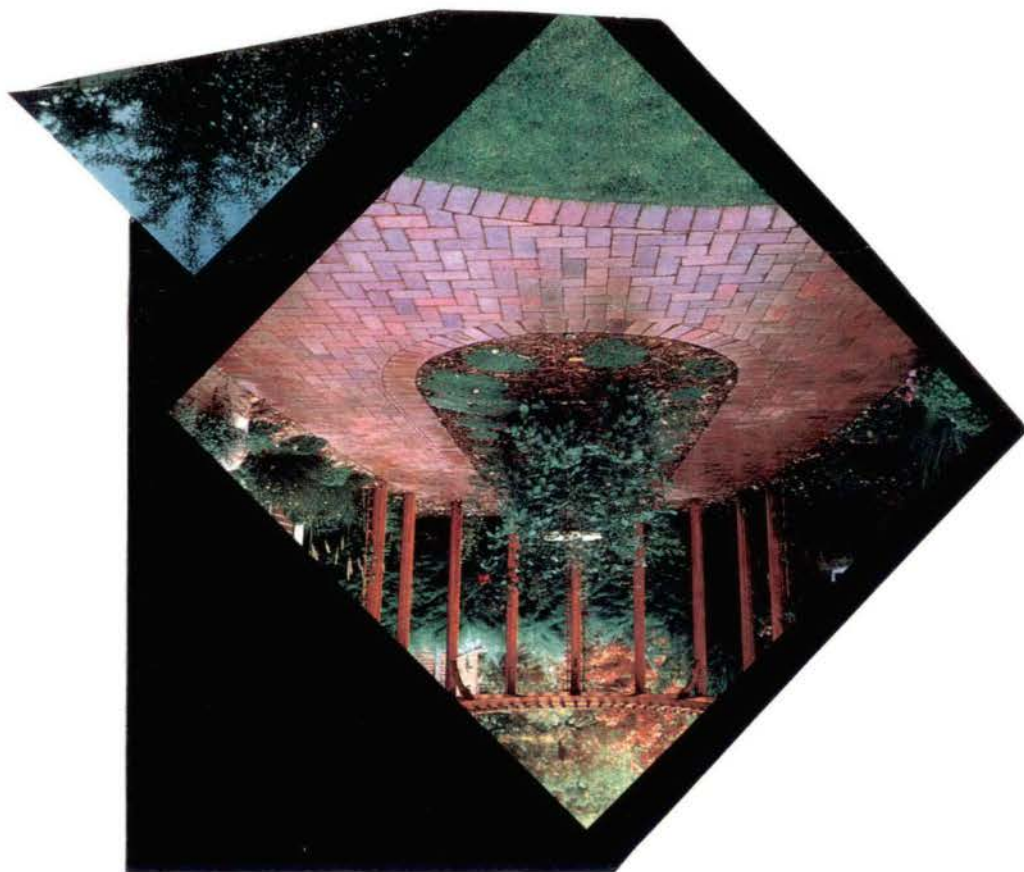

To: JCC Board

From: The Landscaping Committee
Eva Johnston, Scharlene and
Jack Whidden, Natalie Caudill,
Darling Perkins and Chairperson
Kay Evans

The Landscaping Committee has approved plans for the landscaping work that will take place in the front and back yard of Friendly Place, in addition to the patio side of the church. In the design, approved by the committee, is a Memorial Garden located at the rear of Friendly Place House with a Brick Courtyard in the center. The Brick would be engraved with: "In Memory of" or "In Honor of" a person or persons. Each engraved memorial Brick would cost \$30.⁰⁰/₁₀₀. Church members can place orders with our Committee.

We seek approval from the Board for the proposed Brick Courtyard in our Memorial Garden.

See attached Landscaping design.
Kay Evans

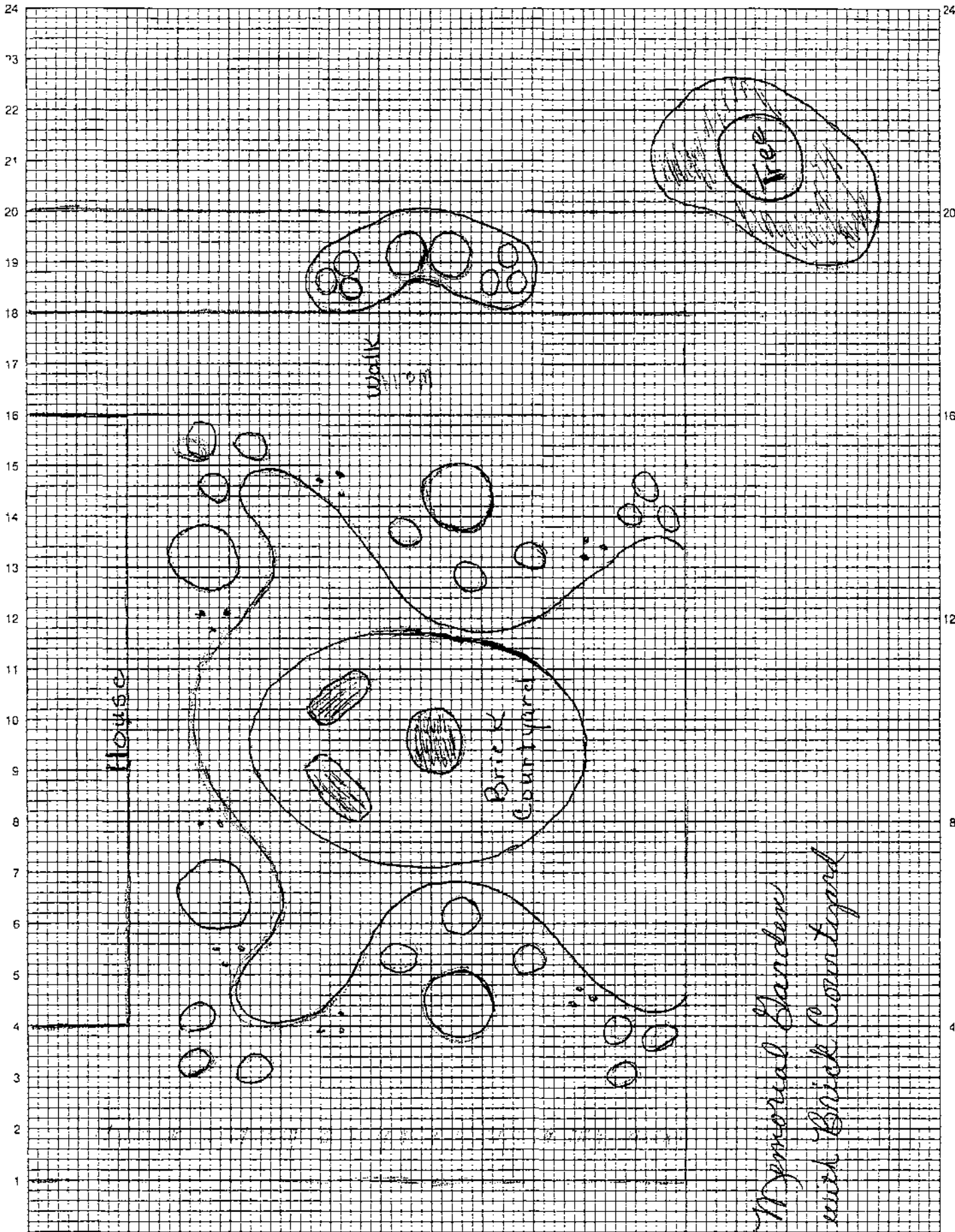

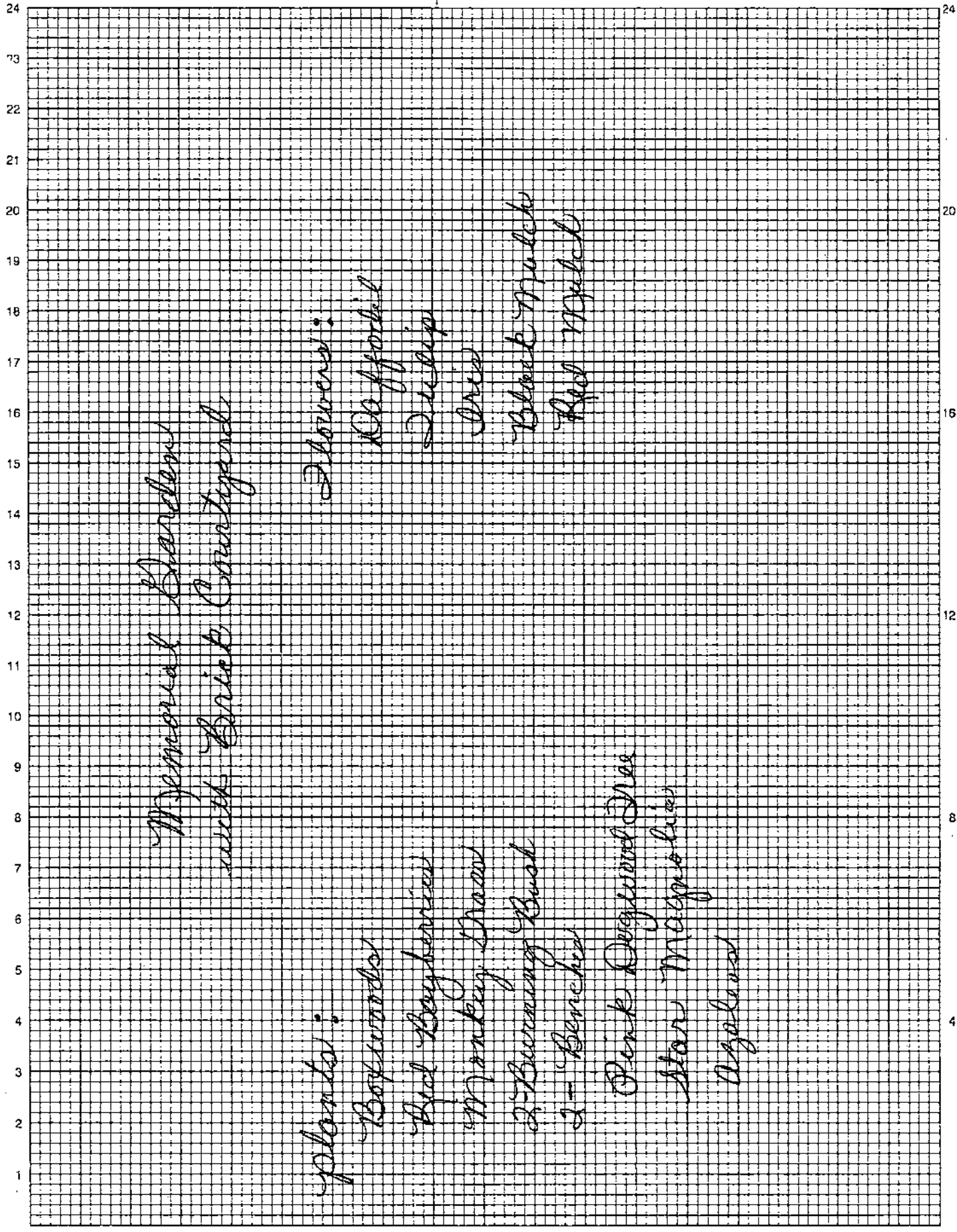

Memorial Garden
with Brick Courtyard

Plants:

- Boxwoods
- Red Bayberry
- Monkey Grass
- 2-Burning Bush
- 2-Benches
- Pink Dogwood Tree
- Star Magnolia
- Azalea

Flowers:

- Daffodil
- Tulip
- Iris
- Black Hydrangea
- Red Hydrangea

**Morehead First Christian Church Board Minutes
Special Meeting
May 9, 2001**

President Al Evans called the meeting to order on May 9, 2001 at 6:30 p.m. Anne Buckner opened the meeting with prayer. Attending the meeting were Betty Hall, Shirley Parker, Glenn and Eva Johnston, Ron and Natalie Caudill, Linda Bryant, Kay and Al Evans, Scharline Whidden, Dianna Reynolds, Debbi Glass, Rex and Sarah Chaney, Mickey and Elizabeth Reffitt, Wayne Caldwell, Connie Hamilton, Katherine Caudill, Peggie Reynolds, Mabel Reynolds, Anne Buckner, Bill and Jeanne Huie, Alta and Don Blair, Neva and Tommy Griffith, Pearl Patton, David and Darlene Perkins, and Larry Fannin.

Ron Caudill reported that the Pulpit Committee had met for the last fourteen months in their search for a new minister and expressed his appreciation for all the prayers during that time. He informed the Board that the committee was recommending Dr. John Dunstan for the position as Morehead First Christian Church Minister at a salary of \$60,000 per year.

After lengthy discussion and deliberation, a motion was made by Rex Chaney and seconded by Tommy Griffith that the Board recommends to the congregation that Dr. John Dunstan be hired. The motion was passed and the recommendation will be made at the Congregational Meeting to be held after Sunday services on May 13, 2001.

Linda Bryant closed the meeting with prayer.

Morehead First Christian Church Board Minutes
May 28, 2001

President Al Evans called the meeting to order on May 28, 2001 at 7:40 p.m. Anne Buckner opened the meeting with prayer. Attending the meeting were Ron and Natalie Caudill, Dianna and Ron Walke, Scharline Whidden, Anne and Glen Buckner, Al and Kay Evans, Neva and Tommy Griffith, David Perkins, Larry Fannin, Shirley Parker, Sarah and Rex Chaney, Peggie Reynolds, Betty Hall, Mabel Reynolds and Dianna Reynolds.

The Board approved the minutes from the last meeting following a motion from Dianna Walke and a second by Peggie Reynolds. The board approved the minutes from the May 9, 2001 special meeting following a motion from Ron Walke and a second by Sarah Chaney.

The Board approved the Treasurer's report following a motion from Peggie Reynolds and a second by Glen Buckner.

The following Committee reports were given:

CWF: Mabel Reynolds reminded the board that vacation time was upon us and to remember the travel toiletries for the "Shelter Tub". Neva Griffith would be collecting money for the flowers for Fathers' Day. The quarterly meeting of the CWF group would be held on June 24th at 4 p.m. at the home of Marge Thomas. Drinks will be provided and each attendee should bring a salad or dessert.

DEACONS: Deacons scheduled to serve in June are Alta Blair, Glen Buckner, Lee Chaney, Al Evans, Fran Helphinstine and Bessie Purnell.

EVANGELISM: Anne Buckner reported that we had a successful Sunday dinner for the rescue squad and city policemen. Larry Fannin expressed his appreciation for Rex Chaney's involvement in making our guests feel welcome.

LIVING MEMORIAL: Shirley Parker reported that numerous gifts were given in memory of Thomas Queen, David Brewster, Dora Hutchinson Williams and Helen Patrick. A summary of gifts for the current year will appear in the June Echo.

PERSONNEL: Larry Fannin advised the board that the credit report on Dr. Dunstan had been received. We have also received the criminal report from the state of Kentucky. We are to receive the criminal report from the state of Virginia. The Board discussed the reports received in detail and determined there was nothing that would prevent him from performing his duties as our Minister. Al Evans reported that Rev. Bob Franz would stay with us until Dr. Dunstan arrives on July 17, 2001.

No reports were received from Education, Stewardship, Elders, Worship, Property, World Outreach, and Project 2000.

Rev. Franz was unable to attend the meeting, but left a brief report with the Board. He urged the congregation "to continue checking on those who miss worship and continue to invite new persons to come to church with us"

There was no old business discussed. Under new business, Kay Evans suggested that we do something for Rev. Bob Franz. Rev. Franz has requested that we not do anything elaborate, therefore Kay suggested a coffee before Sunday church services. The Board decided to delay this decision until the next meeting.

Natalie Caudill closed the meeting with prayer.

Respectfully Submitted,

Shirley Parker, Secretary

INTERIM MINISTER'S REPORT

Since the last Board Meeting the life of our congregation continues to move forward in a positive way. There is a spirit of appreciation for the work of the search committee and a sense of anticipation for the arrival of the new minister, John Dunstan. Pentecost Sunday and Father's Day were strong celebrations, and Sunday morning attendance continues to hold up, although we are seeing the usual summertime slippage. We need to remember that even though we may go on vacation the costs and expenses of the church do not. A number of individuals and families have experienced illness and loss and we need to continue to remember and reach out to them. Vickie Wilson and A. J. Blank placed their membership here, we want to help them feel at home. We need to remember how fortunate we are, to count our blessings, and to continue to turn to God for guidance and help in our lives, especially in these times of transition and change. I continue to feel privileged to have the opportunity to serve God with each of you.

Sincerely,

Bob Franz

First Christian Church
Morehead, Kentucky
Executive Board
May 28, 2001

The Executive/Personnel Committee meeting was called to order by Al Evans. The reports concerning Rev. John Dunstan were discussed and reviewed. The Personnel Committee will recommend the hiring of Rev. Dunstan to the full board. Larry Fannin also urged that the committee share the contract with the entire congregation. This will be accomplished by a mailing as soon as Rev. Dunstan has agreed to the terms of the Contract.

Those attending the meeting were Sarah Chaney, Natalie Caudill, Al Evans, Tommy Griffith, Larry Fannin, Shirley Parker, David Perkins and Ron Caudill.

Note: The Personnel Committee met on the following Sunday to discuss further the contract sent to Rev. Dunstan. Several changes were made to the wording of the contract in accordance with Rev. Dunstan's wishes. The Committee agreed to all of the changes.

1:52 PM

02/22/11

Cash Basis

First Christian Church of Morehead Income & Expense vs Budget - YTD

July 2009 through June 2010



	Jul '09 - Jun 10	Budget	\$ Over Budget
Ordinary Income/Expense			
Income			
4000 · INCOME			
4100 · Contributions			
4105 · Christian Care Communities	1,036.00		
4110 · Christmas	298.00		
4115 · Easter	270.00		
4125 · Operations	151,261.61		
4130 · Pentecost	190.00		
4135 · Reconciliation	877.00		
4140 · Thanksgiving	284.00		
4145 · Week of Compassion	1,312.00		
4150 · Restricted Gifts	525.00		
Total 4100 · Contributions	156,053.61		
4200 · Other Income			
4240 · Interest Earned - Checking	14.36		
Total 4200 · Other Income	14.36		
Total 4000 · INCOME	156,067.97		
Total Income	156,067.97		
Expense			
66900 · Reconciliation Discrepancies	(10.68)		
6000 · EXPENSES			
6100 · Administration			
6110 · Copier Expenses	5,666.47	5,700.00	(33.53)
6120 · Postage	796.47	1,100.00	(303.53)
6130 · Telecom	1,446.42	1,700.00	(253.58)
6140 · Office Supplies	1,864.57	2,200.00	(335.43)
6150 · Miscellaneous	433.17	900.00	(466.83)
Total 6100 · Administration	10,207.10	11,600.00	(1,392.90)
6200 · Personnel			
6270 · Youth Leader	5,200.08	8,500.00	(3,299.92)
6245 · Musician 2	10,040.00	5,200.00	4,840.00
6210 · Minister			
6211 · Salary	32,610.63	33,540.00	(929.37)
6213 · Housing	21,648.00	21,648.00	0.00
6214 · Ministerial Expenses			
6214-B · Professional Expenses	1,224.00	1,224.00	0.00
6214-A · Auto Expenses	4,944.00	4,944.00	0.00
Total 6214 · Ministerial Expenses	6,168.00	6,168.00	0.00
6215 · Medical/Dental	4,824.00	4,824.00	0.00
Total 6210 · Minister	65,250.63	66,180.00	(929.37)
6220 · Secretary	12,350.00	12,400.00	(50.00)
6230 · Custodian	3,400.08	3,400.00	0.08
6240 · Musician	150.00	5,200.00	(5,050.00)
6250 · Choir Dir	4,768.79	5,450.00	(681.21)
6260 · Nursery Attendant	1,640.00	1,040.00	600.00
6280 · Honoraria	150.00	500.00	(350.00)
6285 · Employer's SS	2,226.33	1,965.00	261.33
6290 · Employer's Medicare	520.68	460.00	60.68
6295 · Worker's Comp Ins	0.00	530.00	(530.00)
Total 6200 · Personnel	105,696.59	110,825.00	(5,128.41)
6300 · Property			
6340 · Miscellaneous	166.28	900.00	(733.72)
6310 · Operation & Maintenance	2,655.84	8,000.00	(5,344.16)
6311 · Grounds Care	1,814.27	1,500.00	314.27
6320 · Insurance	8,337.63	7,700.00	637.63
6330 · Utilities/Services			
6331 · Electricity	4,134.47		
6332 · Sewer-Water-Gas	3,855.42		

1:52 PM

02/22/11

Cash Basis

First Christian Church of Morehead Income & Expense vs Budget - YTD

July 2009 through June 2010

	Jul '09 - Jun 10	Budget	\$ Over Budget
6333 · Solid Waste	154.00		
6330 · Utilities/Services - Other	0.00	10,525.00	(10,525.00)
Total 6330 · Utilities/Services	8,143.89	10,525.00	(2,381.11)
Total 6300 · Property	21,117.91	28,625.00	(7,507.09)
6400 · Education			
6410 · Christian Ed. Material	1,168.53	1,200.00	(31.47)
6420 · Vacation Bible School	35.85	300.00	(264.15)
6430 · Youth Activities	1,375.17	1,500.00	(124.83)
6440 · Camp Fees	0.00	400.00	(400.00)
6450 · Gifts - Grads & Teachers	570.29	200.00	370.29
6400 · Education - Other	254.00		
Total 6400 · Education	3,403.84	3,600.00	(196.16)
6500 · Evnglsm & Membership			
6520 · Television Ministry	2,000.00	3,600.00	(1,600.00)
6510 · Membership Development	598.98	1,000.00	(401.02)
6500 · Evnglsm & Membership - Other	69.94		
Total 6500 · Evnglsm & Membership	2,668.92	4,600.00	(1,931.08)
6600 · Outreach			
6610 · Pledge - Disciple Mission Fund	0.00	5,000.00	(5,000.00)
6620 · Special Offerings			
6621 · Easter	270.00		
6622 · Christmas	298.00		
6623 · Pentecost	190.00		
6624 · Reconciliation	877.00		
6625 · Thanksgiving	284.00		
6626 · Week of Compassion	1,312.00		
Total 6620 · Special Offerings	3,231.00		
6630 · Christian Care Communities	1,036.00		
6650 · KY Council of Churches	0.00	300.00	(300.00)
Total 6600 · Outreach	4,267.00	5,300.00	(1,033.00)
6700 · Stewardship	0.00	200.00	(200.00)
6800 · Worship			
6810 · Bell Maintenance	508.99	150.00	358.99
6820 · Candles & Flowers	318.50	450.00	(131.50)
6830 · Choral Supplies	30.40	300.00	(269.60)
6840 · Communion Supplies	220.92	500.00	(279.08)
6850 · Organ Maintenance	1,115.00	1,000.00	115.00
6860 · Piano Maintenance	810.00	250.00	560.00
6870 · Printed Material	81.45	300.00	(218.55)
6880 · Seasonal Decorations	78.71		
6890 · Guest Musicians	200.00	500.00	(300.00)
6895 · Miscellaneous	70.59	300.00	(229.41)
Total 6800 · Worship	3,434.56	3,750.00	(315.44)
Total 6000 · EXPENSES	150,795.92	168,500.00	(17,704.08)
Total Expense	150,785.24	168,500.00	(17,714.76)
Net Ordinary Income	5,282.73	(168,500.00)	173,782.73
Net Income	5,282.73	(168,500.00)	173,782.73

168
 17
 TSP

FIRST CHRISTIAN CHURCH

BUDGET TO ACTUAL COMPARISON

		1/23/01	To	5/28/01	
		Budgeted 2001	This Month's Income	Income Year to Date	
4000	INCOME:				
4105	Christian Church Homes		141.50	163.50	
4110	Christmas				
4115	Easter		-	563.00	
4120	Heifer Project		25.00	278.00	
4125	Operations	139,090.00	7,370.20	52,098.27	86,991.73
4130	Pentecost		25.00	25.00	
4135	Reconciliation				
4140	Thanksgiving				
4145	Week of Compassion		50.00	687.00	
4150	Special Restricted Gift				
4155	Other Contributions		110.00	140.00	
4210	Miscellaneous				
4220	Program/Event Fees			405.00	
4230	Reimbursed Expenses			67.50	
	Total Income	139,090.00	7,721.70	54,427.27	
		Budgeted 2001	This Month's Expenses	Expenses Year to Date	Variation \$0.00 Under (\$0.00) Over
6000	EXPENSES:				
6100	ADMINISTRATION				
6110	Copier Supplies & Maint.	2,500.00	189.50	1,049.84	1,450.16
6120	Postage	1,000.00	68.00	425.96	574.04
6130	Telephone	1,500.00	141.05	651.42	848.58
6140	Office Supplies	2,200.00	182.43	463.86	1,736.14
6150	Miscellaneous	600.00	54.57	339.27	260.73
	Total Administration	7,800.00	635.55	2,930.35	4,869.65
6200	Personnel				
6210	Minister	51,962.00	5,402.11	17,843.44	34,118.56
6215	Pulpit Committee	5,000.00	328.28	583.75	
6220	Secretary	12,000.00	1,515.43	4,901.06	7,098.94
6230	Custodian	2,600.00	355.20	1,121.50	1,478.50
6240	Musician	3,780.00	606.64	1,551.64	2,228.36
6250	Choir Dir	3,780.00	606.64	1,880.10	1,899.90
6260	Nursery Attendant	1,040.00	175.50	415.50	624.50
6270	Student or Assoc. Minister	7,800.00			7,800.00
6275	Minister's Expenses	1,000.00			1,000.00
6280	Honoraria	300.00	125.00	250.00	50.00
6285	Employer's SS	1,948.00	242.64	601.64	1,346.36
6290	Employer's Medicare	455.00	56.77	140.74	314.26
6295	Workers Compensation	1,350.00		518.84	831.16
	Total Personnel	93,015.00	9,414.21	29,808.21	58,790.54
6300	PROPERTY				
6310	Maintenance	10,000.00	61.69	1,400.46	8,599.54
6320	Insurance	3,600.00		3,710.85	(110.85)

6330	Utilities	10,000.00	904.78	5,620.03	4,379.97
6331	Electricity		213.28	993.05	
6332	Sewer-Water-Gas		665.50	4,561.98	
6333	Solid Waste		26.00	65.00	
	Total Property	23,600.00	968.47	10,731.34	12,868.66
6400	EDUCATION				
6410	Christian Ed Material	600.00	230.66	457.54	142.46
6420	Vacation Bible School	150.00		214.00	(64.00)
6430	Youth Activities	500.00	60.00	60.00	440.00
6440	Camp Fees	500.00	-	135.00	365.00
6450	Gifts - Grads & Teachers	125.00	119.99	119.99	5.01
	Total Education	1,875.00	410.65	986.53	888.47
6500	EVANGELISM & MEMBERSHIP				
6510	Supplies & Expenses	800.00	148.30	488.85	311.15
	Total Membership	800.00	148.30	488.85	311.15
6600	OUTREACH				
6610	Pledge - BMF	6,000.00	-	4,000.00	2,000.00
6620	Special Offerings		-	1,200.00	(1,200.00)
6630	Christian Church Homes		141.50	448.50	(448.50)
6640	Heifer Project		50.00	278.00	(278.00)
6650	KY Council of Churches	100.00			100.00
6660	Local Outreach				-
6670	Human Concerns Funding	500.00			500.00
	Total Outreach	6,600.00	191.50	5,926.50	673.50
6700	STEWARDSHIP				
6710	Supplies & Expenses	200.00		16.72	-
	Total Stewardship	200.00	-	16.72	-
6800	WORSHIP				
6810	Bell Maintenance	150.00			150.00
6820	Candles & Flowers	600.00		8.39	591.61
6830	Choral Supplies	750.00	145.34	145.34	604.66
6840	Communion Supplies	450.00	67.07	74.95	375.05
6850	Organ Maintenance	1,200.00	-	376.00	824.00
6860	Piano Maintenance	200.00	-	225.00	(25.00)
6870	Printed Material	900.00	24.49	95.69	804.31
6880	Seasonal Decorations	250.00		50.00	200.00
6890	Miscellaneous	300.00		36.91	263.09
6895	Guest Musicians	400.00		100.00	300.00
	Total Worship	5,200.00	236.90	1,112.28	3,787.72
	Subtotal Expenses		12,003.68	52,000.78	
7000	Non budgeted Expenses				
7100	Program/Event Expense			429.00	(429.00)
7300	Capital Expenditures			1,655.70	(1,655.70)
7500	Uncategorized Expenses		110.00	157.70	(157.70)
	Total Non-Budgeted	-	110.00	2,242.40	(2,064.70)
	TOTAL EXPENSES	139,090.00	12,113.58	54,243.18	
	NET INCOME(LOSS)		(4,391.88)	184.09	
	Bank Balance		1/1/01	6,495.32	
	Bank Balance		5/28/01	\$6,679.41	

Morehead First Christian Church Board Meeting
June 25, 2001

President Al Evans rapped the salt shaker at 7:30 p.m. to call the meeting to order. Betty Hall opened the meeting with prayer. Those attending were David and Darlene Perkins, Dan and Marge Thomas, Sarah Chaney, Natalie and Ron Caudill, Wayne and Hedy Caldwell, Di and Ron Walke, Jeanne Huie, Donna Corley, Linda Bryant, Betty Hall, Tommy and Neva Griffith, Mickey Reffitt, Larry Fannin, Don and Alta Blair, Glen Buckner, Al Evans, Fran Helphinstine and Shirley Parker.

The Board approved the minutes from the last meeting following a motion from Dianna Walke and a second by Fran Helphinstine. The Board approved the Treasurer's report following a motion from Fran Helphinstine and a second by Jeanne Huie.

The following committee reports were given:

CWF: 19 women attended the picnic held at the home of Marge Thomas on June 24th. They discussed having a "Meals on Wheels" program for the elderly and for people at home after hospital stays. On July 29th, a coffee at 10 a.m. will be held for Rev. Bob Franz. Sunday school will be canceled on that morning. The committee members for the coffee will be Kay Evans, Betty Hall, Marge Thomas, Peggie Reynolds and Sarah Chaney. On August 5th, there will be a dinner after church to welcome Dr. John Dunstan. The Pulpit Committee, Ron and Di Walke's flocks will be in charge of that dinner. A baby shower will be held on July 12th for Kristi Davis Skaggs. The CWF is planning several day trips and those will be announced later. The new co-chairs of the Bereavement Committee are Donna Corley and Connie Hamilton. They will take over January 1, 2002.

DEACONS: The Deacons for the month of July are Neva Griffith, Linda Bryant, Scharline Whidden, Dan Thomas, Bill Huie and Debbie Glass.

ELDERS: The Elders will meet on Sunday, July 1st for a short meeting immediately after church services.

PERSONNEL: Final Draft of Dr. Dunstan's contract was received. He will be here on August 1st.

PROPERTY: Mickey Reffitt advised that we had been having telephone problems and that Verizon had offered the church a maintenance contract for \$187.50 a year. The Board approved the contract following a motion from Ron Caudill and a second by Ron Walke.

LIVING MEMORIAL: Shirley Parker reported that gifts were still being received in memory of David Brewster, Thomas Queen and Dixie Helphinstine.

WORSHIP: Jeanne Huie advised that Bob Bradley would be the new Worship Chairman effective July 1, 2001.

There were no reports from the following committees: Education, Evangelism, Stewardship and World Outreach.

Under old Business, Wayne Caldwell advised that we had not yet received the Virginia criminal report on Dr. Dunstan.

Larry Fannin asked for continued commitment to church during this last month of Bob Franz' tenure. He said the greatest gift we could give Bob was to reaffirm our commitment.

Ron Caudill closed the meeting with prayer.

Respectfully Submitted,

A handwritten signature in cursive script that reads "Shirley Parker". The signature is written in dark ink and is positioned above the typed name.

Shirley Parker, Secretary

**First Christian Church
Executive Board Meeting
June 25, 2001**

The following items were discussed at the Executive Board Meeting:

- Brief discussion concerning John Dunstan's move to Morehead.
- The position of choir director at the church was discussed.
- The possibility that the church may need a new nursery attendant.
- The Deacons and officers should be installed as soon as possible.

Those attending the meeting were Sarah Chaney, Natalie Caudill, Jeanne Huie, Shirley Parker, Al Evans, Wayne Caldwell, David Perkins, Larry Fannin and Tommy Griffith.

INTERIM MINISTER'S REPORT

Since the last Board Meeting the life of our congregation continues to move forward in a positive way. There is a spirit of appreciation for the work of the search committee and a sense of anticipation for the arrival of the new minister, John Dunstan. Pentecost Sunday and Father's Day were strong celebrations, and Sunday morning attendance continues to hold up, although we are seeing the usual summertime slippage. We need to remember that even though we may go on vacation the costs and expenses of the church do not. A number of individuals and families have experienced illness and loss and we need to continue to remember and reach out to them. Vickie Wilson and A. J. Blank placed their membership here, we want to help them feel at home. We need to remember how fortunate we are, to count our blessings, and to continue to turn to God for guidance and help in our lives, especially in these times of transition and change. I continue to feel privileged to have the opportunity to serve God with each of you.

Sincerely,

Bob Franz

Living Memorial Fund Gifts

In Memory of Helen Patrick Crosley -2001

Jack and Peggy Bizzel
Mary Ellen Helwig
Glenn and Eva Johnston
Pat and Jean Serey
Carol Hall
Mike Hogge
Ruby Vencill
Martha Leigh Hall
Terry and Nancy Jackson
George and Mary Alfrey
Byron and Helen Wentz
Faye P. Singleton

In Memory of David Brewster-2001

Tommy and Neva Griffith
Ron and Dianna Walke
Glenn and Eva Johnston
Ival and Linda Bryant
Fran Helphinstine

In Memory of Arnold Griffith -2001

Kenneth and Betty Hall

In Memory of Heloise Hurt - 2001

Pearl Patton

In Memory of Dixie Helphinstine - 2001

Kenneth and Betty Hall
Tommy and Neva Griffith
Shirley Parker
Pearl Patton
Regina Mack
C. Nelson and Wilma Grote
Larry and Barbara Fannin
Dan and Marge Thomas

In Memory of Thomas Queen - 2001

Glenn and Eva Johnston
Ival and Linda Bryant
Fran Helphinstine

The gifts for Helen Crosley Patrick were inadvertently left out of last month's Echo.
Please accept my apologies for this error. - Shirley Parker

The gifts to the Living Memorial Fund go to the principal of the fund. The interest earned on the principal is used to make capital improvements to our church.

FIRST CHRISTIAN CHURCH

BUDGET TO ACTUAL COMPARISON

		1/1/01	To	6/25/01	
		Budgeted 2001	This Month's Income	Income Year to Date	
4000	INCOME:				
4105	Christian Church Homes			163.50	
4110	Christmas				
4115	Easter			563.00	
4120	Heifer Project			278.00	
4125	Operations	139,090.00	9,299.50	61,397.77	77,692.23
4130	Pentecost		233.00	258.00	
4135	Reconciliation				
4140	Thanksgiving				
4145	Week of Compassion			687.00	
4150	Special Restricted Gift				
4155	Other Contributions			140.00	
4210	Miscellaneous		60.00	60.00	
4220	Program/Event Fees			405.00	
4230	Reimbursed Expenses			67.50	
	Total Income	139,090.00	9,592.50	64,019.77	
		Budgeted 2001	This Month's Expenses	Expenses Year to Date	Variation \$0.00 Under (\$0.00) Over
6000	EXPENSES:				
6100	ADMINISTRATION				
6110	Copier Supplies & Maint.	2,500.00		1,049.84	1,450.16
6120	Postage	1,000.00		425.96	574.04
6130	Telephone	1,500.00	116.84	768.26	731.74
6140	Office Supplies	2,200.00	74.16	538.02	1,661.98
6150	Miscellaneous	600.00	26.13	365.40	234.60
	Total Administration	7,800.00	217.13	3,147.48	4,652.52
6200	Personnel				
6210	Minister	51,962.00	1,716.55	19,307.53	32,654.47
6215	Pulpit Committee	5,000.00	111.05	694.80	
6220	Secretary	12,000.00	469.58	5,263.95	6,736.05
6230	Custodian	2,600.00	115.38	1,227.82	1,372.18
6240	Musician	3,780.00	24.10	1,551.64	2,228.36
6250	Choir Dir	3,780.00	38.23	1,880.10	1,899.90
6260	Nursery Attendant	1,040.00	6.12	415.50	624.50
6270	Student or Assoc. Minister	7,800.00			7,800.00
6275	Minister's Expenses	1,000.00			1,000.00
6280	Honoraria	300.00	125.00	375.00	(75.00)
6285	Employer's SS	1,948.00	82.36	601.64	1,346.36
6290	Employer's Medicare	455.00	19.27	140.74	314.26
6295	Workers Compensation	1,350.00		518.84	831.16
	Total Personnel	93,015.00	2,707.64	31,977.56	56,732.24
6300	PROPERTY				
6310	Maintenance	10,000.00	286.94	1,687.40	8,312.60
6320	Insurance	3,600.00		3,710.85	(110.85)

6330	Utilities	10,000.00	486.86	6,106.89	3,893.11
6331	Electricity		240.01	1,233.06	
6332	Sewer-Water-Gas		233.85	4,795.83	
6333	Solid Waste		13.00	78.00	
	Total Property	23,600.00	773.80	11,505.14	12,094.86
6400	EDUCATION				
6410	Christian Ed Material	600.00		457.54	142.46
6420	Vacation Bible School	150.00		214.00	(64.00)
6430	Youth Activities	500.00		60.00	440.00
6440	Camp Fees	500.00		135.00	365.00
6450	Gifts - Grads & Teachers	125.00		119.99	5.01
	Total Education	1,875.00	-	986.53	888.47
6500	EVANGELISM & MEMBERSHIP				
6510	Supplies & Expenses	800.00		488.85	311.15
	Total Membership	800.00	-	488.85	311.15
6600	OUTREACH				
6610	Pledge - BMF	6,000.00	2,000.00	6,000.00	-
6620	Special Offerings		283.00	1,483.00	(1,483.00)
6630	Christian Church Homes			448.50	(448.50)
6640	Heifer Project			278.00	(278.00)
6650	KY Council of Churches	100.00			100.00
6660	Local Outreach				-
6670	Human Concerns Funding	500.00			500.00
	Total Outreach	6,600.00	2,283.00	8,209.50	(1,609.50)
6700	STEWARDSHIP				
6710	Supplies & Expenses	200.00		16.72	-
	Total Stewardship	200.00	-	16.72	-
6800	WORSHIP				
6810	Bell Maintenance	150.00			150.00
6820	Candles & Flowers	600.00		8.39	591.61
6830	Choral Supplies	750.00	93.00	238.34	511.66
6840	Communion Supplies	450.00	10.98	85.93	364.07
6850	Organ Maintenance	1,200.00		376.00	824.00
6860	Piano Maintenance	200.00		225.00	(25.00)
6870	Printed Material	900.00		95.69	804.31
6880	Seasonal Decorations	250.00		50.00	200.00
6890	Miscellaneous	300.00		36.91	263.09
6895	Guest Musicians	400.00		100.00	300.00
	Total Worship	5,200.00	103.98	1,216.26	3,683.74
	Subtotal Expenses		6,085.55	57,548.04	
7000	Non budgeted Expenses				
7100	Program/Event Expense			429.00	(429.00)
7300	Capital Expenditures			1,655.70	(1,655.70)
7500	Uncategorized Expenses			157.70	(157.70)
	Total Non-Budgeted	-	-	2,242.40	(2,084.70)
	TOTAL EXPENSES	139,090.00	6,085.55	59,790.44	
	NET INCOME(LOSS)		3,506.95	4,229.33	
		Bank Balance	1/1/01	6,495.32	
		Bank Balance	6/25/01	\$10,724.65	

GENERAL MINISTER & REGION PROFILE SURVEY

Part of the process of calling a new General Minister for our region requires we create a profile of the region and of the position of General Minister. In order to do that, we need input from as many people as possible.

We are asking you to complete the very short survey below and to provide this survey to members of your congregation if applicable. This can be accomplished as an insert in your bulletin/newsletter, by giving time in Board meetings to discuss these questions or by whatever other means you find appropriate.

The more input we receive, the better chance we have of calling the right person to lead our region. We really can't emphasize how important it is that we receive this information.

We would like to have your responses by July 1st. Responses can be mailed to Bill Bramblet, Chair, General Minister Search Committee, Christian Church (Disciples of Christ) In Kentucky, 1125 Red Mile Rd., Lexington, KY 40504.

What do you see as the strengths of our Region?

What are the areas in which you think our Region could improve?

What characteristics/qualities do you think we should be looking for in our next General Minister?

Are there any other comments you would like to make that might help us in our search?

Morehead First Christian Church
Monthly Board Meeting
June 25, 2001

1. CALL TO ORDER Al Evans, President
2. OPENING PRAYER
3. PREVIOUS MEETINGS MINUTES
4. TREASURER'S REPORT David Perkins, Treasurer
5. COMMITTEE REPORTS:
 - CWF
 - DEACONS

 - EDUCATION
 - ELDERS

 - EVANGELISM
 - LIVING MEMORIAL
 - PERSONNEL
 - PROPERTY

 - STEWARDSHIP
 - WORLD OUTREACH
 - WORSHIP
6. MINISTER'S REPORT
7. OLD BUSINESS
8. NEW BUSINESS
9. CLOSING PRAYER

Morehead First Christian Church Board Meeting
July 23, 2001

President Al Evans called the meeting to order at 7:30 p.m. Tommy Griffith opened the meeting with prayer. Those attending were Larry Fannin, Betty Hall, Tommy and Neva Griffith, Hedy and Wayne Caldwell, Bob Bradley, Donna Corley, Al Evans, Sarah Chaney, Bill Davis, Dan Thomas, Don Blair, David Perkins, Jack and Scharline Whidden, Fran Helphinstine, Glenn and Eva Johnston and Shirley Parker.

The Board approved the minutes from the last meeting following a motion from Fran Helphinstine and a second by Tommy Griffith. The Board approved the Treasurer's report following a motion from Eva Johnston and a second by Fran Helphinstine.

The following committee reports were given:

CWF: Sarah Chaney advised that a baby shower had been given for Christy Skaggs and there would be a double baby shower for Tiffany Clark and Dianna Reynolds.

DEACONS: Sarah Chaney asked for volunteers for the month of August. Donna Corley volunteered. The other volunteers were not named.

EDUCATION: Vacation Bible School will be held from August 8, 2001 through August 11, 2001 from 5:30 p.m. until 8 p.m. Eva Johnston reported the Bible School would have a "Habitat for Humanity" theme. She also advised that the Presbyterian Church would participate with parents and children. Al Evans advised that the Catholic Church had also expressed an interest in participating.

ELDERS: No report.

EVANGELISM: Wayne Caldwell advised that he had called the city park and that September and October Sundays were available, but that we should make our reservations for the annual fall picnic as soon as possible.

LIVING MEMORIAL: Shirley Parker reported that memorial gifts had been received in the month of July for David Brewster, Thomas Queen, Arnold Griffith, Dixie Helphinstine, Harold Jackson and Robert Walther, Sr.

PERSONNEL: Al Evans reported Rev. John Dunstan had visited Morehead with his fiancée. The couple had made an offer on a home in the area. Rev. Dunstan was to have been married on July 20, 2001. In other matters, Rev. Dunstan had expressed a desire to interview any choir director applicants. Al also reported that time off had been granted to Rev. Bob Franz.

PROPERTY: Jack Whidden, who is the new property chairperson, addressed the new contract with Verizon for telephone service.

STEWARDSHIP: Al Evans had met with Dr. Grote concerning the Stewardship Committee. There will be three meetings during the year to prepare for the stewardship drive. Dr. Grote wants five people to serve on this committee.

WORLD OUTREACH: Donna Corley, the new chair of the committee, advised that July 25, 2001 would be the fifth Sunday.

WORSHIP: Bob Bradley, the new chair of the committee, gave the board an extensive report on his plans and hopes for the coming year. Dan Thomas, Eva Johnston, Kathy Williams and Donna Corley, Hedy Caldwell (ex-officio) and the new choir director (ex-officio) will serve on the committee. During the month of August, there will be a team approach to the choir rehearsals with Myron Doan playing and Hedy Caldwell singing or leading as needed. The Board approved the report from Bob Bradley following a motion by Larry Fannin and a second by Don Blair.

The Interim Minister's report was given to the Board. Rev. Franz wrote that he had enjoyed his time here and was grateful for having had the opportunity to be a part of such an outstanding group of people. Larry Fannin stated that over the past several weeks, the church had gained new members, had a baptism and several reaffirmations. He stated that he felt this was a positive recognition of what Bob Franz had done for our church. He felt that Reverend Franz had given the church a detailed blueprint for our future during the last few weeks. That blueprint consists of prayer, increased spirituality, and support for each other and unconditional support for the new minister.

There will be a coffee for Rev. Franz next Sunday morning at 10 a.m. The memorial bricks for the memorial garden will also be displayed at that time.

David Perkins advised there was an IRS requirement that the \$1,500 housing allowance to be given to Rev. Dunstan must be approved by the board. The Board approved this item following a motion by Wayne Caldwell and a second by Glenn Johnston.

Betty Hall closed the meeting with prayer

Respectfully Submitted,

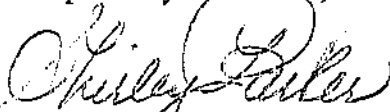

Shirley Parker, Secretary

FIRST CHRISTIAN CHURCH

BUDGET TO ACTUAL COMPARISON

		1/1/01	To	7/27/01	
		Budgeted 2001	This Month's Income	Income Year to Date	
4000	INCOME:				
4105	Christian Church Homes		228.00	391.50	
4110	Christmas				
4115	Easter			563.00	
4120	Heifer Project			278.00	
4125	Operations	139,090.00	8,406.42	79,273.33	59,816.67
4130	Pentecost			258.00	
4135	Reconciliation				
4140	Thanksgiving				
4145	Week of Compassion			687.00	
4150	Special Restricted Gift				
4155	Other Contributions			140.00	
4210	Miscellaneous		210.00	480.00	
4220	Program/Event Fees			605.00	
4230	Reimbursed Expenses			162.46	
	Total Income	139,090.00	8,844.42	82,838.29	
		Budgeted 2001	This Month's Expenses	Expenses Year to Date	Variation \$0.00 Under (\$0.00) Over
6000	EXPENSES:				
6100	ADMINISTRATION				
6110	Copier Supplies & Maint.	2,500.00	189.50	1,618.34	881.66
6120	Postage	1,000.00	68.00	629.96	370.04
6130	Telephone	1,500.00	120.03	1,199.67	300.33
6140	Office Supplies	2,200.00		608.38	1,591.62
6150	Miscellaneous	600.00	113.95	532.73	67.27
	Total Administration	7,800.00	491.48	4,589.08	3,210.92
6200	Personnel				
6210	Minister	51,962.00	3,969.01	27,410.32	24,551.68
6215	Pulpit Committee	5,000.00		794.80	4,205.20
6220	Secretary	12,000.00	939.16	7,324.79	4,675.21
6230	Custodian	2,600.00	230.76	1,707.04	892.96
6240	Musician	3,780.00	303.32	2,193.32	1,586.68
6250	Choir Dir	3,780.00	303.32	2,521.78	1,258.22
6260	Nursery Attendant	1,040.00	97.50	597.50	442.50
6270	Student or Assoc. Minister	7,800.00			7,800.00
6275	Minister's Expenses	1,000.00			1,000.00
6280	Honoraria	300.00		375.00	(75.00)
6285	Employer's SS	1,948.00	121.94	844.28	1,103.72
6290	Employer's Medicare	455.00	28.53	197.51	257.49
6295	Workers Compensation	1,350.00		518.84	831.16
	Total Personnel	93,015.00	5,993.54	44,485.18	48,529.82
6300	PROPERTY				
6310	Maintenance	10,000.00	363.08	2,303.78	7,696.22
6320	Insurance	3,600.00		3,710.85	(110.85)

6330	Utilities	10,000.00	504.77	7,064.47	2,935.53
6331	Electricity		383.38	1,905.45	
6332	Sewer-Water-Gas		108.39	5,055.02	
6333	Solid Waste		13.00	104.00	
	Total Property	23,600.00	867.85	13,079.10	10,520.90
6400	EDUCATION				
6410	Christian Ed Material	600.00	86.85	576.06	23.94
6420	Vacation Bible School	150.00	266.07	480.07	(330.07)
6430	Youth Activities	500.00		60.00	440.00
6440	Camp Fees	500.00		135.00	365.00
6450	Gifts - Grads & Teachers	125.00	282.33	402.32	(277.32)
	Total Education	1,875.00	635.25	1,653.45	221.55
6500	EVANGELISM & MEMBERSHIP				
6510	Supplies & Expenses	800.00		488.85	311.15
	Total Membership	800.00		488.85	311.15
6600	OUTREACH				
6610	Pledge - BMF	6,000.00		6,000.00	-
6620	Special Offerings			1,483.00	(1,483.00)
6630	Christian Church Homes		228.00	676.50	(676.50)
6640	Heifer Project			278.00	(278.00)
6650	KY Council of Churches	100.00			100.00
6660	Local Outreach				-
6670	Human Concerns Funding	500.00	500.00	500.00	-
	Total Outreach	6,600.00	728.00	8,937.50	(2,337.50)
6700	STEWARDSHIP				
6710	Supplies & Expenses	200.00		16.72	183.28
	Total Stewardship	200.00	-	16.72	183.28
6800	WORSHIP				
6810	Bell Maintenance	150.00			150.00
6820	Candles & Flowers	600.00		18.39	581.61
6830	Choral Supplies	750.00	75.46	313.80	436.20
6840	Communion Supplies	450.00	37.18	123.11	326.89
6850	Organ Maintenance	1,200.00		376.00	824.00
6860	Piano Maintenance	200.00		225.00	(25.00)
6870	Printed Material	900.00		95.69	804.31
6880	Seasonal Decorations	250.00		50.00	200.00
6890	Miscellaneous	300.00		51.73	248.27
6895	Guest Musicians	400.00		100.00	300.00
	Total Worship	5,200.00	112.64	1,353.72	3,546.28
	Subtotal Expenses		8,828.76	74,603.60	
7000	Non budgeted Expenses				
7100	Program/Event Expense			629.00	(629.00)
7300	Capital Expenditures			1,655.70	(1,655.70)
7500	Uncategorized Expenses			157.70	(157.70)
	Total Non-Budgeted			2,442.40	(2,284.70)
	TOTAL EXPENSES	139,090.00	8,828.76	77,046.00	
	NET INCOME(LOSS)		15.66	5,792.29	
		Bank Balance	1/1/01	6,495.32	
		Bank Balance	7/27/01	\$12,287.61	

FUNDS INVESTED WITH CHRISTIAN CHURCH FOUNDATION

-FUNDS	73,473.00	-	
IFH-FUNDS	29,800.00	—	FUND BALANCE AS OF 9-24-93
REGISTER	1,000.00	-/	
OTHER	1,727.00		PART OF INCOME FROM 1992 & 1993
	106,000.00		INITIAL INVESTMENT WITH FOUNDATION

DATE	PRINCIPAL	INCOME	WITH DRAWALS	BALANCE
09-24-93	106,000.00			106,000.00
09-30-93		23.86		106,023.86
12-31-93		1,157.65		107,181.51
03-18-94	1,000.00			108,181.51
03-31-94		0.82		108,182.33
03-31-94		541.21		108,723.54
03-31-94		370.86		109,094.40
04-03-94		0.25		109,094.65
05-09-94	30,500.00			139,594.65
06-30-94		55.55		139,650.20
06-30-94		88.44		139,738.64
06-30-94		968.51		140,707.15
09-30-94		1,151.14		141,858.29
12-27-94	2,000.00			143,858.29
31-94		0.54		143,858.83
12-31-94		1,352.78		145,211.61
03-31-95		1,307.41		146,519.02
06-30-95		1,560.18		148,079.20
09-30-95		1,440.98	(5,150.00)	144,370.18
12-31-95	5,400.00			149,770.18
12-31-95		1,721.78		151,491.96
03-31-96		1,438.98		152,930.94
06-12-96	8,075.00			161,005.94
06-12-96		387.21		161,393.15
06-30-96		21.37		161,414.52
06-30-96		1,437.61		162,852.13
09-30-96		1,610.21		164,462.34
12-31-96		2,204.40		166,666.74
03-31-97		1,560.15		168,226.89
06-30-97		1,514.06		169,740.95
09-30-97		1,540.83		171,281.78
12-31-97		4,985.22		176,267.00
03-31-98		1,695.11	(12,000.00)	165,962.11
06-30-98		1,774.35		167,736.46
08-31-98		1.17		167,737.63
31-98		32.60		167,770.23
09-30-98	5,000.00			172,770.23
09-30-98	3,000.00			175,770.23
09-30-98		1,794.85		177,565.08
12-31-98	99,000.00			276,565.08

12-31-98		15.43		276,580.51
12-31-98		152.98		276,733.49
12-31-98		6,212.43		282,945.92
03-31-99		4,308.79	(13,800.00)	273,454.71
05-12-99	20,000.00			293,454.71
06-01-99		47.98		293,502.69
06-30-99		4,155.14		297,657.83
07-01-99		71.35		297,729.18
09-30-99		4,497.79		302,226.97
10-31-99		1,460.65		303,687.62
11-30-99		1,477.65		305,165.27
12-31-99		1,507.58		306,672.85
01-31-00		1,597.09		308,269.94
02-29-00		1,530.48		309,800.42
03-16-00	5,000.00			314,800.42
03-31-00		1,559.74		316,360.16
04-30-00		1,647.99		318,008.15
05-31-00		1,584.95		319,593.10
06-30-00		1,557.39		321,150.49
07-31-00		1,590.40		322,740.89
08-31-00		1,572.50		324,313.39
09-30-00		1,653.38		325,966.77
10-31-00		1,627.42		327,594.19
11-30-00		1,604.05		329,198.24
12-31-00		1,535.68		330,733.92
01-31-01		1,584.03		332,317.95
02-28-01		1,635.16		333,953.11
03-31-01		1,569.15		335,522.26
04-30-01		1,512.60		337,034.86
05-31-01		1,575.86		338,610.72
05-31-01		194.96		338,805.68
06-01-01	50,000.00			388,805.68
06-01-01	9,000.00			397,805.68
06-30-01		1,832.18		399,637.86
				399,637.86
				399,637.86
TOTALS	343,975.00	86,612.86	(30,950.00)	399,637.86
1/0/00	CURRENT BOOK VALUE			399,637.86

LMF / IFH FUNDS

6-30-01

FUND PRINCIPAL

LIVING MEMORIAL FUND.....	12-31-00	260,197.55
GIFTS THIS YEAR		<u>4,830.00</u>
LMF BALANCE		265,027.55
 Inez Faith Humphrey Fund.....		45,800.00
GIFTS THIS YEAR		<u>150,000.00</u>
I F H FUND BALANCE.....		<u>195,800.00</u>
TOTAL CURRENT FUND PRINCIPAL, ALL FUNDS	6-30-01	<u>460,827.55</u>

TOTAL ASSETS - ALL LOCATIONS

Principal & Income

CHECKING - LOCAL	6-30-01	6,499.54
 CD in Peoples Bank	Matures 4-24-2002	100,000.00
 CHRISTIAN CHURCH FOUNDATION.....	6-30-01	399,637.86
(Current Book Value)		
	TOTAL.....	<u>506,137.40</u>

INCOME

PREVIOUS YEARS INCOME THROUGH.....	12-31-00	78,435.92
CURRENT YEAR'S INCOME THROUGH.....	6-30-01	<u>9,903.94</u>
TOTAL INCOME		88,339.86

INCOME - MOST RECENT QUARTER.....		<u>5,115.60</u>
Portion spendable under LMF rules	73.45%	3,757.40
Portion spendable under IFH rules	26.55%	1,358.20
	100.00%	

SPENDABLE - LMF	73,972.16
SPENT LMF.....	39,268.60
 SPENDABLE - IFH	14,367.70
SPENT IFH	3,800.00

UNSPENT INCOME

LMF	34,703.56
IFH	10,567.70

TOTAL UNSPENT INCOME.....	<u>45,271.26</u>
----------------------------------	-------------------------

Other assets belonging to Operations account

- * **CD @ Fristar Bank - Approximately \$7,000**
- * **198 Shares of IBM Stock held by Soloman Smith Barney**
(Per share price @ close of business 8-24-01 - \$106.99)

INTERIM MINISTERS REPORT

In June we continued to see some of the changes that occur. During the summer months. June 30, marks the end of the church year and July 1, marks the beginning of a new one. We are grateful to those whose terms of service have ended, and we appreciate those who accepted positions of leadership for the coming year.

The church remains in good condition, moving in a positive direction; its next major event is the welcoming of its new minister, John Dunstan.

I have enjoyed my time here and remain grateful for having had the opportunity to be a part of such an outstanding group of people. God Bless each of you.

Sincerely,

Bob Franz

Living Memorial Fund Gifts

July 2001

In Memory of David Brewster-2001

Jack and Scharline Whidden
Glen and Anne Buckner

In Memory of Dixie Helphinstine – 2001

Jack and Scharline Whidden
Glenn and Eva Johnston
Ron and Natalie Caudill
Glen and Anne Buckner

In Memory of Robert Walther –2001

Fran Helphinstine
Mary Margaret Reynolds
William and Phyllis Bradley
Pearl Patton
Tommy and Neva Griffith
C. Nelson and Wilma Grote
Regina Mack

In Memory of Harold Jackson –2001

Ron and Natalie Caudill
Tommy and Neva Griffith
C. Nelson and Wilma Grote
Glenn and Eva Johnston
Fran Helphinstine
Shirley Parker

In Memory of Arnold Griffith– 2001

Glen and Anne Buckner

In Memory of Thomas Queen - 2001

Glen and Anne Buckner

The gifts to the Living Memorial Fund go to the principal of the fund. The interest earned on the principal is used to make capital improvements to our church.

Morehead First Christian Church
Monthly Board Meeting
July 23, 2001

1. CALL TO ORDER Al Evans, President
2. OPENING PRAYER
3. PREVIOUS MEETINGS MINUTES
4. TREASURER'S REPORT David Perkins, Treasurer
5. COMMITTEE REPORTS:

CWF
DEACONS

EDUCATION
ELDERS

EVANGELISM
LIVING MEMORIAL
PERSONNEL
PROPERTY

STEWARDSHIP
WORLD OUTREACH
WORSHIP
6. MINISTER'S REPORT
7. OLD BUSINESS
8. NEW BUSINESS
9. CLOSING PRAYER

Morehead First Christian Church Board Meeting
August 27, 2001

President Al Evans called the meeting to order at 7:40 p.m. Jack Whidden opened the meeting with prayer. Those attending were Donna Corley, Dan and Marge Thomas, Bill and Jeanne Huie, David Perkins, Larry Fannin, Don Blair, Al and Kay Evans, Joe Macke, Peggie Reynolds, Jack and Scharline Whidden, Tommy and Neva Griffith, Betty Hall, Glenn Johnston, Wayne and Hedy Caldwell, Bob Bradley, Fran Helphinstine, Bill and Margaret Davis, Mickey and Elizabeth Reffitt, Shirley Parker and Dr. John Dunstan.

The minutes from the last meeting were corrected to state that Myron Doan was being paid at a rate of \$30 per Sunday during the month of August. The minutes were approved as amended following a motion from Fran Helphinstine and a second by Glenn Johnston.

The Board approved the Treasurer's report following a motion from Elizabeth Reffitt and a second by Fran Helphinstine.

The following committee reports were given:

CWF: Neva Griffith reminded everyone that toiletries for shelter were needed by September 9, 2001.

DEACONS: EVANGELISM No report

ELDERS: Tommy Griffith advised that the Elders met on September 18 and were scheduled for Sunday Morning services through October 28, 2001. He also advised that the Church Picnic would be held on September 30, 2001 at 4:30 at the church.

LIVING MEMORIAL: Shirley Parker announced that gifts were received during the month of August in memory of Rev. William Huie, Minnie Swader, Harold Jackson, Dixie Helphinstine, Robert Walther, David Brewster, Kim Anne Moulton and in Honor of Rev. Robert Franz. David Perkins gave a comprehensive financial explanation of the Living Memorial Fund and the Inez Faith Humphrey Fund as of June 30, 2001.

PERSONNEL: John Dunstan, Bob Bradley and the Personnel Committee recommended the hiring of Sandra Derby as Choir Director. She will be paid \$5,000 for one year in monthly increments. Ms. Derby will have nine weeks off during the year and volunteers and staff will lead the choir at that time.

PROPERTY: Jack Whidden told the Board that Joe Macke had given him a list of over 35 items that needed attention. The Board was reminded that Joe was the custodian and not hired to be a repairman. Jack said the stairwell just inside the door needed to be painted and suggested a "Painting Party" to accomplish this task. He also said the basement in the Hogge House flooded during the last rain and that the problem seemed to be the downspouts and the windows. He will obtain estimates to correct. The Baptistery

in the sanctuary was discussed. Margaret Davis moved that this problem be corrected immediately followed by a second from Elizabeth Reffit. A friendly amendment was added to look into the possibility of enlarging the space for the choir at the same time the baptistery was repaired. The Board passed this amendment and motion. Jack also recommended a look at the electrical system and replacement of the pews in the church.

STEWARDSHIP: A second statement has been prepared by the Stewardship Committee and will appear in the September Echo. Joyce Hart, Soni Lytle, Joe Macke and Gayle Tingle have joined the committee. Al Evans and John Dunstan will serve in an ex-officio capacity. Nelson and Wilma Grote are co-chairs of the committee.

WORLD OUTREACH: Donna Corley announced that the fifth Sunday would be held on September 30, 2001. The committee will announce the special giving Sundays the week before and also on the exact Sunday. The members of the committee are Marge Thomas, Connie Hamilton, Donna Corley, Alta and Don Blair, and Betty Hall.

WORSHIP: Bob Bradley reported that Yvonne Baldwin had agreed to do floral arrangements for the Sunday morning worship service. Mr. Bradley also apologized to the Board for the misunderstanding at the previous Sunday service.

Dr. John Dunstan shared his pastor's report with the Board. He said that there were four ingredients to a happy, healthy church: a) a warm caring organization; b) a friendly pastor; c) a great music program and d) a good youth program. Dr. Dunstan expressed his desire to obtain a youth minister to run the church's youth program. The Board agreed that this was a need for our church.

David Perkins asked the board to approve the change in the minister's housing allowance for the year 2001. This change did not affect the bottom line of the minister's salary, only the allocation. The Board approved this action as recommended by the Personnel Committee.

Dr. Dunstan closed the meeting with prayer.

Respectfully submitted,



Shirley Parker, Board Secretary

**Morehead First Christian Church
Monthly Board Meeting
September 24, 2001**

1. CALL TO ORDER Al Evans, President
2. OPENING PRAYER
3. PREVIOUS MEETINGS MINUTES
4. TREASURER'S REPORT David Perkins, Treasurer
5. COMMITTEE REPORTS:
 - CWF
 - DEACONS

 - EDUCATION
 - ELDERS

 - EVANGELISM
 - LIVING MEMORIAL
 - PERSONNEL
 - PROPERTY

 - STEWARDSHIP
 - WORLD OUTREACH
 - WORSHIP
6. MINISTER'S REPORT
7. OLD BUSINESS
8. NEW BUSINESS
9. CLOSING PRAYER

**Morehead First Christian Church Board Meeting
September 24, 2001**

President Al Evans called the meeting to order at 7:30 p.m. Ron Walke opened the meeting with prayer. Those attending were Peggie Reynolds, Glenn and Eva Johnston, Bill and Margaret Davis, Bill and Jeanne Huie, Al Evans, Donna Corley, Betty Hall, Wayne and Hedwine Caldwell, Dan and Marge Thomas, Ron and Di Walke, David Perkins, Jack Whidden, Glen and Anne Buckner, Neva Griffith, Linda Bryant, Alta Blair, Shirley Parker and Rev. John Dunstan.

The Board approved the minutes from the last meeting following a motion from Bill Davis and a second by Alta Blair. The Board approved the treasurer's report following a motion from Linda Bryant and a second by Shirley Parker.

The following committee reports were given:

CWF: Anne Buckner reminded everyone that the CWF retreat was to be held at Jenny Wiley State Park on October 27 and 28, 2001.

EDUCATION: Di Walke advised the one more member was needed for the committee. She also informed the Board that Linda Bryant and Darlene Perkins had subbed as Sunday school teachers for the month of September. Starting in October, Neva Griffith will be the children's Teacher.

EVANGELISM: Anne Buckner reported that the evangelism committee had not met during the past month, but were sponsoring the Fish Fry to be held at the church at 4:30 on September 30, 2001.

LIVING MEMORIAL: Shirley Parker advised that gifts had been received during the month of September for Rev. William Huie and Forrest Wells.

PERSONNEL: Al Evans advised that Nora Mullins had requested vacation for the week of October 8, 2001. The Board approved this request after a motion from Ron Walke and a second by Glenn Johnston. Al Evans also announced that Bob Bradley had resigned as Worship Chairman.

STEWARDSHIP: Dr. Grote sent an e-mail message to the Board concerning the Stewardship Committee. The same theme will be "WHERE YOUR TREASURE IS THERE WILL YOUR HEAR BE ALSO" as last year's stewardship drive.

WORLD OUTREACH: Donna Corley advised that there would be a fifth Sunday offering on September 30, 2001 for the Christian Church Homes and a minute for mission in October.

There were no reports from the following committees: Deacons, Elders, Property and Worship.

Rev. Dunstan shared with the Board that the Rev. Jan Ehrmantraut would be with us on October 28th for his installation.

The board also discussed the attendance books in the sanctuary and the fact that they were not being looked at after the Sunday Service. It was suggested that in place of attendance books, that visitor card might be more informative. Sarah Chaney presently keeps track of attendance at each Sunday Morning Service. It was felt that the attendance books should also be used to highlight any regular church attendees who were not coming and to use this information to contact those members.

In new business, Wayne Caldwell discussed the children who had been attending the last few Sunday mornings. Because we are blessed to have these children, it was suggested that the congregation welcome them and be tolerant of their behavior.

David Perkins suggested that the monthly payments to the Telephone Company for Internet connection (approximately \$50) be discontinued. The use of the Internet system has greatly diminished and could be connected to the original telephone line. Shirley Parker moved to disconnect the second line for Internet connection. The Board approved this motion following a second by Bill Davis.

David Perkins asked the Board to move the appropriation of \$800 from Housing to his Medical reimbursement. The board approved this switch in allocation of monies following a motion by Ron Walke and a second by Bill Huie.

Dr. John Dunstan closed the meeting with prayer.

Respectfully Submitted,

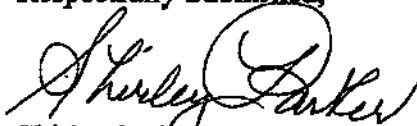

Shirley Parker, Secretary

FIRST CHRISTIAN CHURCH

BUDGET TO ACTUAL COMPARISON

		1/1/01	To	9/24/01	
		Budgeted 2001	This Month's Income	Income Year to Date	
4000	INCOME:				
4105	Christian Church Homes		55.00	446.50	
4110	Christmas				
4115	Easter			563.00	
4120	Heifer Project			278.00	
4125	Operations	139,090.00	8,130.17	87,403.50	51,686.50
4130	Pentecost			258.00	
4135	Reconciliation				
4140	Thanksgiving				
4145	Week of Compassion			687.00	
4150	Special Restricted Gift				
4155	Other Contributions			140.00	
4210	Miscellaneous		270.00	750.00	
4220	Program/Event Fees			605.00	
4230	Reimbursed Expenses			182.46	
	Total Income	139,090.00	8,455.17	91,313.46	
		Budgeted 2001	This Month's Expenses	Expenses Year to Date	Variation \$0.00 Under (\$0.00) Over
6000	EXPENSES:				
6100	ADMINISTRATION				
6110	Copier Supplies & Maint.	2,500.00	-	1,618.34	881.66
6120	Postage	1,000.00	75.00	704.96	295.04
6130	Telephone	1,500.00	139.19	1,338.86	161.14
6140	Office Supplies	2,200.00		608.38	1,591.62
6150	Miscellaneous	600.00	79.97	612.68	(12.68)
	Total Administration	7,800.00	294.16	4,883.22	2,916.78
6200	Personnel				
6210	Minister	51,962.00	3,574.10	30,984.42	20,977.58
6215	Pulpit Committee	5,000.00	4,505.51	5,300.31	(300.31)
6220	Secretary	12,000.00	940.42	8,265.21	3,734.79
6230	Custodian	2,600.00	230.60	1,937.64	662.36
6240	Musician	3,780.00	303.74	2,497.06	1,282.94
6250	Choir Dir	3,780.00	120.00	2,641.78	1,138.22
6260	Nursery Attendant	1,040.00	78.00	675.50	364.50
6270	Student or Assoc. Minister	7,800.00			7,800.00
6275	Minister's Expenses	1,000.00			1,000.00
6280	Honoraria	300.00		375.00	(75.00)
6285	Employer's SS	1,948.00	101.17	945.45	1,002.55
6290	Employer's Medicare	455.00	23.67	221.18	233.82
6295	Workers Compensation	1,350.00		518.84	831.16
	Total Personnel	93,015.00	9,877.21	54,362.39	38,652.61
6300	PROPERTY				
6310	Maintenance	10,000.00	192.20	2,495.98	7,504.02
6320	Insurance	3,600.00		3,710.85	(110.85)

6330	Utilities	10,000.00	484.13	7,548.60	2,451.40
6331	Electricity		380.05	2,285.50	
6332	Sewer-Water-Gas		91.08	5,146.10	
6333	Solid Waste		13.00	117.00	
	Total Property	23,600.00	676.33	13,755.43	9,844.57
6400	EDUCATION				
6410	Christian Ed Material	600.00		576.06	23.94
6420	Vacation Bible School	150.00		480.07	(330.07)
6430	Youth Activities	500.00		60.00	440.00
6440	Camp Fees	500.00		135.00	365.00
6450	Gifts - Grads & Teachers	125.00		402.32	(277.32)
	Total Education	1,875.00	-	1,653.45	221.55
6500	EVANGELISM & MEMBERSHIP				
6510	Supplies & Expenses	800.00	45.32	534.17	265.83
	Total Membership	800.00	45.32	534.17	265.83
6600	OUTREACH				
6610	Pledge - BMF	6,000.00		6,000.00	-
6620	Special Offerings			1,483.00	(1,483.00)
6630	Christian Church Homes			676.50	(676.50)
6640	Heifer Project			278.00	(278.00)
6650	KY Council of Churches	100.00			100.00
6660	Local Outreach				-
6670	Human Concerns Funding	500.00		500.00	-
	Total Outreach	6,600.00	-	8,937.50	(2,337.50)
6700	STEWARDSHIP				
6710	Supplies & Expenses	200.00		16.72	183.28
	Total Stewardship	200.00	-	16.72	183.28
6800	WORSHIP				
6810	Bell Maintenance	150.00			150.00
6820	Candles & Flowers	600.00		18.39	581.61
6830	Choral Supplies	750.00		313.80	436.20
6840	Communion Supplies	450.00	11.82	134.93	315.07
6850	Organ Maintenance	1,200.00		376.00	824.00
6860	Piano Maintenance	200.00		225.00	(25.00)
6870	Printed Material	900.00	24.49	120.18	779.82
6880	Seasonal Decorations	250.00		50.00	200.00
6890	Miscellaneous	300.00		51.73	248.27
6895	Guest Musicians	400.00		100.00	300.00
	Total Worship	5,200.00	36.31	1,390.03	3,509.97
	Subtotal Expenses		10,929.33	85,532.91	
7000	Non budgeted Expenses				
7100	Program/Event Expense			629.00	(629.00)
7300	Capital Expenditures			1,655.70	(1,655.70)
7500	Uncategorized Expenses			157.70	(157.70)
	Total Non-Budgeted	-	-	2,442.40	(2,284.70)
	TOTAL EXPENSES	139,090.00	10,929.33	87,975.31	
	NET INCOME(LOSS)		(2,474.16)	3,338.15	
	Bank Balance		1/1/01	6,495.32	
	Bank Balance		9/24/01	\$9,833.47	

Report to the Board
Stewardship Committee

September 24, 2001

The Stewardship Committee met on Wednesday night, August 29 for its' organizational meeting. Initial work was assigned and is now underway. We will be using the same theme ("FOR WHERE YOUR TREASURE IS THERE WILL YOUR HEART BE ALSO") as last year but substantially revised in format and content. John Dunstan and Al Evans will be scheduling a Stewardship Congregational Luncheon, hosted by our committee and will set a date for the Dedication of our Commitments, both to be held in November. The committee will be meeting the weeks of October 15 and 22 nd. A good deal of research concerning pledges, patterns of giving and finance is being conducted.

We are pleased that Ron Walke has joined our committee to help us with financial information and is working closely with David Perkins. We will soon be asking the standing committees to furnish us draft copy for their respective areas of responsibility.

We ask for your continued prayers and support of this important task.

Nelson and Wilma Grote, Co-chairs

We have completed two months of ministry here at First Christian Church. The time has gone very fast.

The four areas that I am initially concerned with are Worship, Office, Visitation, and Hospital work.

Worship.... The worship program appears to be developing in a very positive direction. Our members and leaders have done a strong job of working together during this transition. The worship services are well received. Special thanks to the choir and the bells. I hope attendance increases as we leave summer and move into Thanksgiving and Advent.

Office.... There is still much to do to get accurate lists of membership, mailing lists, and other records, which have been lost. We continue to work at this. Generally, I am pleased with the development of the office work.

Hospital work.... We have been blessed with few hospital stays for our folks. I hope we continue to be this healthy.

Visitation... I have been able to visit with some of our members in the past weeks. This will increase. Everyone please stay home more.

Installation.. The Rev. Jan Ehrmantraut from the regional office will be with us on October 28th for the installation of the pastor.

August 14, 2001

Reference: Vacation Time

Mr. Al Evans
Chairman of Board
227 East Main St.
Morehead, KY 40351

Dear Al & Executive Board Members,

I am writing this, requesting vacation time. This is a little early as I will not be here 1 year until October 23, 2001.

I wish to request vacation for October 8, 2001 through October 12, 2001. This is the only time my husband will be able to be off in October. We are going camping at Cave Run and the camp ground closes October 31, 2001.

I will have the bulletin completed for October 14th and anything else that needs done.

Thank you for taking the time to consider my request.

Sincerely,

Nora Mullins

Nora Mullins
Secretary

*OK OK
8/24/01*

Living Memorial Fund Gifts

August, 2001

In Memory of Rev. William Huie-2001

Jack and Peggy Bizzel
C. Nelson and Wilma Grote
Ronald and Natalie Caudill
Shirley Parker
Thelma Brown
Rex and Sarah Chaney
Glenn and Eva Johnston
Fran Helphinstine
Tommy and Neva Griffith
Hubert and Delia Allen
Kenneth and Betty Hall
Paul J. and Mabel Reynolds
Agnes Williams

In Memory of Minnie Swader-2001

Fran Helphinstine
Tommy and Neva Griffith
Rex and Sarah Chaney
Glenn and Eva Johnston
Kenneth and Betty Hall

In Memory of Harold Jackson -2001

Billie Jean Clayton
Peggie Reynolds
Regina Mack
Rex and Sarah Chaney

In Memory of Dixie Helphinstine -- 2001

Billie Jean Clayton

In Memory of Robert Walther -2001

Katherine Caudill

In Memory of David Brewster

Rex and Sarah Chaney

In Honor of Rev. Robert Franz-2001

Peggie Reynolds
Shirley Parker

In Memory of Kim Anne Moulton-2001

Pearl Patton

The gifts to the Living Memorial Fund go to the principal of the fund. The interest earned on the principal is used to make capital improvements to our church.

**Morehead First Christian Church Board Meeting
October 22, 2001**

President Al Evans called the meeting to order at 7:30 p.m. Rev. John Dunstan opened the meeting with prayer. Those attending were Al and Kay Evans, John Dunstan, Bill Huie, Ron and Dianna Walke, Donna Corley, Ron and Natalie Caudill, Glen and Anne Buckner, Mabel Reynolds, Joe Macke, Phyllis Bradley, Larry Fannin, David Perkins, Dan and Marge Thomas, Rex and Sarah Chaney, Elizabeth Reffitt, Fran Helphinstine, Shirley Parker, Bill and Margaret Davis, and Jack Whidden.

The Board approved the minutes from the last meeting following a motion from Fran Helphinstine and a second by Rex Chaney. The Board approved the treasurer's report following a motion from Ron Walke and a second by Fran Helphinstine.

The following committee reports were given:

CWF: Mabel Reynolds had a letter from Sally Paulselle of Lexington concerning home-made cookies needed for Christian Church youth meeting. The letter will be published in the Echo.

DEACONS: Deacons for the month of November will be Ron and Natalie Caudill, Bill Huie, Fran Helphinstine, Dan Thomas and Donna Corley.

ELDERS: No report.

EDUCATION: Dianne Walke reported that forty or forty-five people were attending Sunday school each week. Neva Griffith is one of the Sunday school teachers. Mo and Layla Sabie have been contacted and may be available on November 4th to meet with the Sunday school classes to discuss the recent World Trade Center disaster.

EVANGELISM: Anne Buckner is updating the membership/attendee rolls and a booklet listing those names will be available soon.

LIVING MEMORIAL: Shirley Parker reported that a gift had been received in memory of Gladys Tuttle (Hubert Allen's sister). David Perkins attached the Living Memorial quarterly report to the monthly Treasurer's report.

PERSONNEL: Al Evans advised that the resignation from Nora Mullins had been accepted.

PROPERTY: Jack Whidden reported that they were still planning on painting the inside entrance by the elevator as soon as possible. He also said that there were some electrical wires near the organ that needed to be covered.

STEWARDSHIP: The Board received a memo from Dr. Grote outlining the progress made by the Stewardship committee. The Stewardship Luncheon has been set for

November 11th. Dedication of the Time and Talent cards is scheduled for November 18th.

WORLD OUTREACH: Donna Corley reported that November would be the Months of Missions and the beginning of Christmas Activity. We received \$276 from the last Reconciliation Sunday.

Rev. Dunstan advised that he had taken a course in Sexual Harassment at the Lexington Theological Seminary on October 22, 2001. He felt that our Sunday services had been enriched by the good music provided by the choir and the bell choir. He said the piano music yesterday was exceptional. He advised that the new secretary, Laura Copher, was a very good worker. She is with Kelly Services and is assigned to our church temporarily. The church may hire Laura at the end of three months to be an employee of the church.

Kay Evans gave a presentation on the Memorial Gardens.

There was some discussion on how the church could attract new and younger members.

Jack Whidden closed the meeting with prayer.

Respectfully Submitted,

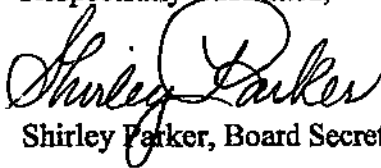
A handwritten signature in cursive script that reads "Shirley Parker". The signature is written in black ink and is positioned above the typed name.

Shirley Parker, Board Secretary

First Christian Church
Executive Board Meeting
October 22, 2001

The following items were discussed at the Executive Board Meeting:

- Nora Mullins' resignation had been received and accepted.
- Laura Copher was the new temporary secretary.
- Worship Committee co-chairs are Eva Johnston and Betty Hall.

Those attending the meeting were Al Evans, David Perkins, Shirley Parker, Elizabeth Reffitt, Sarah Chaney and Rev. John Dunstan.

2002 Stewardship Committee Report

With the aid of e-mail, a great deal of work was accomplished in September and early October. We had a very productive meeting on October 16th. Some materials were given final approval and others will be reviewed and approved at our next meeting on October 24. The quality of work being done is excellent, thanks to outstanding committee members. Tentative dates have been set for each step of the process. A Stewardship Congregational Luncheon has been set for November 11 to be hosted by the 2002 Stewardship Committee, et. al. Dedication of our Estimated Gift cards and our Time and Talent cards is scheduled for Sunday November 18. Appropriate announcements will be included in the Echo, Sunday Bulletins and will be made in person at church services. Our theme will be "For where your treasure is, there will your heart be also". (Matthew 6:21) Questions can be addressed to John, Al, Ron or any other members of the committee in attendance.

Nelson and Wilma Grote

Co-chairs

2002 Stewardship Committee

Minister's Report To Board

October 22, 2001

Worship

The Worship Program continues to develop in a positive direction.

Office

We have a new secretary functioning in the office. We are upgrading and updating files and other materials on a daily basis.

Pastor

Today the pastor is taking a mandatory course in *Sexual Harassment and Misconduct* at the Lexington Theological Seminary.

Rev. Dr. John Dunstan

FIRST CHRISTIAN CHURCH

BUDGET TO ACTUAL COMPARISON

		1/1/01	To	10/22/01	
		Budgeted 2001	This Month's Income	Income Year to Date	
4000	INCOME:				
4105	Christian Church Homes		227.00	673.50	
4110	Christmas				
4115	Easter			563.00	
4120	Heifer Project			278.00	
4125	Operations	139,090.00	8,431.76	95,835.26	43,254.74
4130	Pentecost			258.00	
4135	Reconciliation		276.00	276.00	
4140	Thanksgiving				
4145	Week of Compassion			687.00	
4150	Special Restricted Gift				
4155	Other Contributions			140.00	
4210	Miscellaneous		90.00	840.00	
4220	Program/Event Fees			605.00	
4230	Reimbursed Expenses			182.46	
	Total Income	139,090.00	9,024.76	100,338.22	
		Budgeted 2001	This Month's Expenses	Expenses Year to Date	Variation \$0.00 Under (\$0.00) Over
6000	EXPENSES:				
6100	ADMINISTRATION				
6110	Copier Supplies & Maint.	2,500.00	380.25	1,998.59	501.41
6120	Postage	1,000.00		704.96	295.04
6130	Telephone	1,500.00	133.27	1,472.13	27.87
6140	Office Supplies	2,200.00	14.60	622.98	1,577.02
6150	Miscellaneous	600.00	97.30	709.98	(109.98)
	Total Administration	7,800.00	625.42	5,508.64	2,291.36
6200	Personnel				
6210	Minister	51,962.00	6,475.12	37,459.54	14,502.46
6215	Pulpit Committee	5,000.00		5,300.31	(300.31)
6220	Secretary	12,000.00	1,121.05	9,386.26	2,613.74
6230	Custodian	2,600.00	248.54	2,186.18	413.82
6240	Musician	3,780.00	337.94	2,835.00	945.00
6250	Choir Dir	3,780.00	382.09	3,023.87	756.13
6260	Nursery Attendant	1,040.00	104.60	780.10	259.90
6270	Student or Assoc. Minister	7,800.00			7,800.00
6275	Minister's Expenses	1,000.00			1,000.00
6280	Honoraria	300.00		375.00	(75.00)
6285	Employer's SS	1,948.00	102.41	1,047.86	900.14
6290	Employer's Medicare	455.00	23.96	245.14	209.86
6295	Workers Compensation	1,350.00		518.84	831.16
	Total Personnel	93,015.00	8,795.71	63,158.10	29,856.90
6300	PROPERTY				
6310	Maintenance	10,000.00	131.45	2,627.43	7,372.57
6320	Insurance	3,600.00		3,710.85	(110.85)

6330	Utilities	10,000.00	522.17	8,070.77	1,929.23
6331	Electricity		377.90	2,663.40	
6332	Sewer-Water-Gas		131.27	5,277.37	
6333	Solid Waste		13.00	130.00	
	Total Property	23,600.00	653.62	14,409.05	9,190.95
6400	EDUCATION				
6410	Christian Ed Material	600.00		576.06	23.94
6420	Vacation Bible School	150.00		480.07	(330.07)
6430	Youth Activities	500.00		60.00	440.00
6440	Camp Fees	500.00		135.00	365.00
6450	Gifts - Grads & Teachers	125.00		402.32	(277.32)
	Total Education	1,875.00	-	1,653.45	221.55
6500	EVANGELISM & MEMBERSHIP				
6510	Supplies & Expenses	800.00	191.70	725.87	74.13
	Total Membership	800.00	191.70	725.87	74.13
6600	OUTREACH				
6610	Pledge - BMF	6,000.00		6,000.00	-
6620	Special Offerings		301.00	1,784.00	(1,784.00)
6630	Christian Church Homes		282.00	958.50	(958.50)
6640	Heifer Project			278.00	(278.00)
6650	KY Council of Churches	100.00			100.00
6660	Local Outreach				-
6670	Human Concerns Funding	500.00		500.00	-
	Total Outreach	6,600.00	583.00	9,520.50	(2,920.50)
6700	STEWARDSHIP				
6710	Supplies & Expenses	200.00		16.72	183.28
	Total Stewardship	200.00	-	16.72	183.28
6800	WORSHIP				
6810	Bell Maintenance	150.00			150.00
6820	Candles & Flowers	600.00		18.39	581.61
6830	Choral Supplies	750.00		313.80	436.20
6840	Communion Supplies	450.00		134.93	315.07
6850	Organ Maintenance	1,200.00		376.00	824.00
6860	Piano Maintenance	200.00		225.00	(25.00)
6870	Printed Material	900.00		120.18	779.82
6880	Seasonal Decorations	250.00		50.00	200.00
6890	Miscellaneous	300.00		51.73	248.27
6895	Guest Musicians	400.00		100.00	300.00
	Total Worship	5,200.00	-	1,390.03	3,509.97
	Subtotal Expenses		10,849.45	96,382.36	
7000	Non budgeted Expenses				
7100	Program/Event Expense			629.00	(629.00)
7300	Capital Expenditures			1,655.70	(1,655.70)
7500	Uncategorized Expenses			157.70	(157.70)
	Total Non-Budgeted			2,442.40	(2,284.70)
	TOTAL EXPENSES	139,090.00	10,849.45	98,824.76	
	NET INCOME(LOSS)		(1,824.69)	1,513.46	
	Bank Balance		1/1/01	6,495.32	
	Bank Balance		10/22/01	\$8,008.78	

LMF / IFH FUNDS
9-30-01

FUND PRINCIPAL

LIVING MEMORIAL FUND.....	12-31-00	260,197.55
GIFTS THIS YEAR		5,800.00
LMF BALANCE		265,997.55
 Inez Faith Humphrey Fund.....		 45,800.00
GIFTS THIS YEAR		150,000.00
I F H FUND BALANCE.....		195,800.00
TOTAL CURRENT FUND PRINCIPAL, ALL FUNDS	9-30-01	461,797.55

TOTAL ASSETS - ALL LOCATIONS

Principal & Income

CHECKING - LOCAL	9-30-01	7,114.57
CD in Peoples Bank	Matures 4-24-2002	100,000.00
CHRISTIAN CHURCH FOUNDATION.....	9-30-01	405,013.15
(Current Book Value)		
TOTAL.....		512,127.72

INCOME

PREVIOUS YEARS INCOME THROUGH.....	12-31-00	78,435.92
CURRENT YEAR'S INCOME THROUGH.....	9-30-01	15,279.23
TOTAL INCOME		93,715.15

INCOME - MOST RECENT QUARTER.....		5,375.29
Portion spendable under LMF rules	73.52%	3,951.97
Portion spendable under IFH rules	26.48%	1,423.32
	100.00%	

SPENDABLE - LMF	77,924.13	
SPENT LMF.....	39,336.57	
SPENDABLE - IFH	15,791.02	
SPENT IFH	3,800.00	

UNSPENT INCOME

	LMF	38,587.56
	IFH	11,991.02

TOTAL UNSPENT INCOME.....		50,578.58
----------------------------------	--	------------------

Due to current market conditions, the Market value of our investment with the Christian Church Foundation is less than the Book Value.

What does this mean? If we were to spend all of the funds shown as Unspent Income on the other side of this report we would be spending \$4,189.26 of our principle.

The investment vehicle that we are participating in is almost exactly split between equities (stocks) and income producing instruments (bonds). While the bonds continue to provide income the stock side has lost value. If we were to liquidate now we would have a loss, but since we are in for the long haul this should prove to be a pot hole in the road for the big picture a year or two from now.

FUNDS INVESTED WITH CHRISTIAN CHURCH FOUNDATION

IF-FUNDS	73,473.00	-	
IFH-FUNDS	29,800.00	---	FUND BALANCE AS OF 9-24-93
REGISTER	1,000.00	-/	
OTHER	1,727.00		PART OF INCOME FROM 1992 & 1993
	106,000.00		INITIAL INVESTMENT WITH FOUNDATION

DATE	PRINCIPAL	INCOME	WITH DRAWALS	BALANCE
09-24-93	106,000.00			106,000.00
09-30-93		23.86		106,023.86
12-31-93		1,157.65		107,181.51
03-18-94	1,000.00			108,181.51
03-31-94		0.82		108,182.33
03-31-94		541.21		108,723.54
03-31-94		370.86		109,094.40
04-03-94		0.25		109,094.65
05-09-94	30,500.00			139,594.65
06-30-94		55.55		139,650.20
06-30-94		88.44		139,738.64
06-30-94		968.51		140,707.15
09-30-94		1,151.14		141,858.29
12-27-94	2,000.00			143,858.29
-31-94		0.54		143,858.83
12-31-94		1,352.78		145,211.61
03-31-95		1,307.41		146,519.02
06-30-95		1,560.18		148,079.20
09-30-95		1,440.98	(5,150.00)	144,370.18
12-31-95	5,400.00			149,770.18
12-31-95		1,721.78		151,491.96
03-31-96		1,438.98		152,930.94
06-12-96	8,075.00			161,005.94
06-12-96		387.21		161,393.15
06-30-96		21.37		161,414.52
06-30-96		1,437.61		162,852.13
09-30-96		1,610.21		164,462.34
12-31-96		2,204.40		166,666.74
03-31-97		1,560.15		168,226.89
06-30-97		1,514.06		169,740.95
09-30-97		1,540.83		171,281.78
12-31-97		4,985.22		176,267.00
03-31-98		1,695.11	(12,000.00)	165,962.11
06-30-98		1,774.35		167,736.46
08-31-98		1.17		167,737.63
-31-98		32.60		167,770.23
09-30-98	5,000.00			172,770.23
09-30-98	3,000.00			175,770.23
09-30-98		1,794.85		177,565.08
12-31-98	99,000.00			276,565.08

12-31-98		15.43		276,580.51
12-31-98		152.98		276,733.49
12-31-98		6,212.43		282,945.92
03-31-99		4,308.79	(13,800.00)	273,454.71
05-12-99	20,000.00			293,454.71
06-01-99		47.98		293,502.69
06-30-99		4,155.14		297,657.83
07-01-99		71.35		297,729.18
09-30-99		4,497.79		302,226.97
10-31-99		1,460.65		303,687.62
11-30-99		1,477.65		305,165.27
12-31-99		1,507.58		306,672.85
01-31-00		1,597.09		308,269.94
02-29-00		1,530.48		309,800.42
03-16-00	5,000.00			314,800.42
03-31-00		1,559.74		316,360.16
04-30-00		1,647.99		318,008.15
05-31-00		1,584.95		319,593.10
06-30-00		1,557.39		321,150.49
07-31-00		1,590.40		322,740.89
08-31-00		1,572.50		324,313.39
09-30-00		1,653.38		325,966.77
10-31-00		1,627.42		327,594.19
11-30-00		1,604.05		329,198.24
12-31-00		1,535.68		330,733.92
01-31-01		1,584.03		332,317.95
02-28-01		1,635.16		333,953.11
03-31-01		1,569.15		335,522.26
04-30-01		1,512.60		337,034.86
05-31-01		1,575.86		338,610.72
05-31-01		194.96		338,805.68
06-01-01	50,000.00			388,805.68
06-01-01	9,000.00			397,805.68
06-30-01		1,832.18		399,637.86
07-31-01		1,813.62		401,451.48
08-31-01		1,798.43		403,249.91
09-30-01		1,763.24		405,013.15
				405,013.15
				405,013.15
				405,013.15
				405,013.15
				405,013.15
				405,013.15
				405,013.15
TOTALS	343,975.00	91,988.15	(30,950.00)	405,013.15

1/0/00

CURRENT BOOK VALUE

405,013.15

1995 -- CURRENT Expenditures from LMF / IFH

Approved Expenditures

10-26-95	5,007.04	Sound System
11-01-95	3,967.42	New Hymnals
12-31-95	105.55	Shipping - Hymnals
05-31-96	602.56	Deposit New Phone System
06-06-96	300.00	Carpet - Nursery
08-12-96	1,405.98	Balance on Phone System
09-15-97	409.00	Deposit on Choir Robes
01-05-98	1,823.74	Balance on Choir Robes
04-01-98	12,000.00	Most of new A/C system
03-31-99	13,800.00	New Kitchen
10-01-99	(1,720.00)	Unspent Kitchen - Returned
10-01-00	3,774.68	Insulation - Attic Sanctuary
11-28-00	420.55	Landscaping front of Sanctuary
06-05-01	247.60	Landscaping around Faith Annex

42,144.12

Administrative Cost

10-04-95	69.00	LMF Stationery
02-01-96	19.50	Deposit slip books
11-17-99	6.60	Stamps
12-30-99	6.60	Stamps
03-01-00	13.20	Stamps
03-22-00	13.20	Stamps
12-23-00	6.80	Stamps
03-15-01	265.60	Stamps & Printed material
08-06-01	34.00	Stamps
08-06-01	33.97	Printer Cart

468.47

42,612.59

Offsetting funds from other sources

10-26-95	2,166.56	Special Giving - sound sys
11-01-95	1,000.00	Register gift - Hymnals
11-29-95	85.00	Special giving - Hymnals
12-28-95	24.46	Special giving - Hymnals

3,276.02

39,336.57 Net LMF Earnings spent

Inez Faith Humphrey Fund Expenditures

02-17-99

3,800.00 Down payment on copier

FIRST CHRISTIAN CHURCH
BOARD MEETING
AGENDA
OCTOBER 22, 2001

CALL TO ORDER

OPENING PRAYER

MINUTES

TREASURER'S REPORT

COMMITTEE REPORTS:

CWF
DEACONS
EDUCATION
ELDERS
EVANGELISM/MEMBERSHIP
LIVING MEMORIAL
PERSONNEL
PROPERTY
STEWARDSHIP
WORLD OUTREACH
WORSHIP

MINISTER'S REPORT

OLD BUSINESS

NEW BUSINESS

Morehead First Christian Church Board Meeting
November 26, 2001

President Al Evans called the meeting to order at 7:30 p.m. Rev. John Dunstan opened the meeting with prayer. Those attending were Al Evans, Rex and Sarah Chaney, Glen and Anne Buckner, Tommy and Neva Griffith, Natalie Caudill, Wayne and Hedy Caldwell, Betty Hall, Donna Corley, Dan and Marge Thomas, Bill and Margaret Davis, Mickey and Elizabeth Reffitt, Nelson and Wilma Grote. Fran Helphinstine, Ron and Di Walke, Bill Huie, David Perkins, Shirley Parker and Rev. Dunstan.

The Board approved the minutes from the last meeting following a motion from Fran Helphinstine and a second by Di Walke. The Board approved the treasurer's report following a motion from Fran Helphinstine and a second by Bill Davis.

The following committee reports were given:

PROJECT 2000: Dr. Grote had the Morehead First Christian Church Mission Statement framed and brought it to the Board. An anonymous donor paid for the framing of the Statement. Dr. Grote suggested that the mission statement also be put in the Sunday bulletins once a month to be a constant reminder to our congregation.

STEWARDSHIP: Dr. Grote advised that 30 families had turned in their pledge cards on the 18th of November. Since that time 7 more had been received. Results of the pledges would be unavailable until a later time.

CWF: Di Walke advised that Main Street Christmas still had some unsold tickets. She stated that volunteers were needed to coordinate the Saturday night event. Our church is the smallest of the three churches and she felt we needed to look at the work involved in this event and see if we wanted to continue to participate. Natalie advised that the Goody Trays were going for \$10 each and the orders needed to be in by November 30. The CWF would meet on Tuesday December 4th to put the trays together. It was announced that the CWF made \$85 on the bake sale held in conjunction with the Pancake Breakfast.

DEACONS: Deacons for December will be Bill Davis, Margaret Davis, Mickey Reffitt, Glenn Buckner, Al Evans and Donna Corley.

EDUCATION: Di Walke reported that Dr. Mohammed Sabie spoke to the adult Sunday school Program in November. She told the Board that the Presbyterian Church had been billed for one half the cost in Vacation Bible School and that money was received. She advised that the Steven Grote Sunday School Room needed to be painted.

ELDERS: Tommy Griffith advised that the Elders met on November 4th, and had assignments through January. He advised that the search for a youth minister by the church was ongoing. The search would be coordinated with the Worship and Education Committees

Dr. Don Blair had agreed to pay for an ad to be placed in the Trail Blazer at the University. There was an excellent advertisement in the Morehead News for the church. Tommy was hopeful that the next advertisement would be geared toward the youth of the community. He advised that the Elders would be redoing the Flock lists to put different Elders with different people in the congregation.

EVANGELISM: Anne Buckner advised the cost of the Morehead News advertisement was \$60. She said they were making progress on Membership list.

LIVING MEMORIAL: Memorial gifts are being received for Oran Teater.

PERSONNEL: Al Evans asked Dr. Dunstan how the new secretary was doing. Dr. Dunstan had nothing but praise for Laura Copher. The personnel committee will have to meet before year-end to decide whether to hire Laura on a permanent basis.

PROPERTY: No report.

WORLD OUTREACH: Donna Corley advised that November is Mission Outreach Month. December 30th will be a fifth Sunday. The Thanksgiving offering was \$210. Ron Walke asked the board to approve a donation to Habitat for Humanity for \$500. After discussion, it was decided that Board approval was not necessary and the Outreach Committee could make that decision.

WORSHIP: December 2nd will be a special service. On December 9th, there will be a church dinner. The Secret Place was not in as of November 26th, but the Advent Booklets will go out this week. Communion volunteers are needed for the month of May.

Wayne Caldwell advised that he had heard on very good authority that there was an overwhelming response to the CWF Cookie request. He also thanked the congregation and Molly Dunstan for their cooperation with the two young Jones boys.

Dr. Dunstan advised the need for a Youth Minister should be included in our prayers.

Elizabeth Reffitt extended her thanks to Sarah Chaney for the Pancake Breakfast. She said the response to the Hot Chocolate Treat at the church was small but appreciated. Sarah Chaney advised that the Pancake Breakfast made \$661. Di Walke complimented Donna Corley on the Outreach newsletter sent to the congregation. Dr. Dunstan advised that the Echo Deadline would be Wednesday at noon. Anne Buckner closed the meeting with prayer.

Respectfully Submitted,

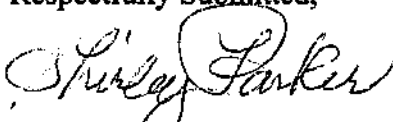

Shirley Parker, Board Secretary

First Christian Church
Executive Board Meeting
November 26, 2001

The following items were discussed at the Executive Board Meeting:

- Dr. John Dunstan's vacation. He would need a substitute Minister for December 30, 2001.
- Nora Mullins had requested one week's vacation and her birthday pay in a letter to Al Evans. Al said the pay was due her according to the contract. The treasurer was instructed to make the payments to Mrs. Mullins.
- The Christian Church advertisement in the Morehead News. The next one should be geared more toward the community youth.
- The position of youth minister needs to be advertised.
- Sandra Derby would be gone on the 16th and 23rd of December. Myron Doan would be helping on those Sundays.

Those attending the meeting were Elizabeth Reffitt, Sarah Chaney, Al Evans, Wayne Caldwell, Tommy Griffith, David Perkins, Shirley Parker and Dr. John Dunstan.

FIRST CHRISTIAN CHURCH

BUDGET TO ACTUAL COMPARISON

		01/01/2001	To	12/31/2001	
		Budgeted 2001	This Month's Income	Income Year to Date	
4000	INCOME:				
4105	Christian Church Homes		220.00	893.50	
4110	Christmas		158.00	158.00	
4115	Easter			563.00	
4120	Heifer Project		1,890.00	2,193.00	
4125	Operations	139,736.68	9,894.11	114,148.55	25,588.13
4130	Pentecost			258.00	
4135	Reconciliation			276.00	
4140	Thanksgiving		25.00	235.00	
4145	Week of Compassion			687.00	
4150	Special Restricted Gift				
4155	Other Contributions		132.00	313.34	
4210	Miscellaneous		30.00	1,290.00	
4220	Program/Event Fees		208.00	813.00	
4230	Reimbursed Expenses		11.00	433.00	
	Total Income	139,736.68	12,568.11	122,261.39	
		Budgeted 2001	This Month's Expenses	Expenses Year to Date	Variation \$0.00 Under (\$0.00) Over
6000	EXPENSES:				
6100	ADMINISTRATION				
6110	Copier Supplies & Maint.	2,500.00	189.50	2,377.59	122.41
6120	Postage	1,000.00	222.00	1,028.96	(28.96)
6130	Telephone	1,500.00	67.09	1,577.78	(77.78)
6140	Office Supplies	2,200.00	230.37	983.33	1,216.67
6150	Miscellaneous	600.00	94.94	1,076.02	(476.02)
	Total Administration	7,800.00	803.90	7,043.68	756.32
6200	Personnel				
6210	Minister	51,962.00	6,547.46	47,654.93	4,307.07
6215	Pulpit Committee	5,000.00		5,300.31	(300.31)
6220	Secretary	12,000.00	1,488.82	12,104.47	(104.47)
6230	Custodian	2,840.00	373.06	2,789.84	50.16
6240	Musician	3,780.00	641.26	3,780.00	-
6250	Choir Dir	4,186.68	862.10	4,320.03	(133.35)
6260	Nursery Attendant	1,040.00	181.50	1,020.10	19.90
6270	Student or Assoc. Minister	7,800.00			7,800.00
6275	Minister's Expenses	1,000.00			1,000.00
6280	Honoraria	300.00		475.00	(175.00)
6285	Employer's SS	1,948.00	146.74	1,315.19	632.81
6290	Employer's Medicare	455.00	34.34	307.69	147.31
6295	Workers Compensation	1,350.00		518.84	831.16
	Total Personnel	93,661.68	10,275.28	79,586.40	14,075.28
6300	PROPERTY				
6310	Maintenance	10,000.00	67.20	2,799.44	7,200.56
6320	Insurance	3,600.00		3,710.85	(110.85)

6330	Utilities	10,000.00	544.11	8,950.09	1,049.91
6331	Electricity		302.58	3,116.19	
6332	Sewer-Water-Gas		228.53	5,677.90	
6333	Solid Waste		13.00	156.00	
	Total Property	23,600.00	611.31	15,460.38	8,139.62
6400	EDUCATION				
6410	Christian Ed Material	600.00	91.10	715.78	(115.78)
6420	Vacation Bible School	150.00		480.07	(330.07)
6430	Youth Activities	500.00	14.79	74.79	425.21
6440	Camp Fees	500.00		135.00	365.00
6450	Gifts - Grads & Teachers	125.00		432.32	(307.32)
	Total Education	1,875.00	105.89	1,837.96	37.04
6500	EVANGELISM & MEMBERSHIP				
6510	Supplies & Expenses	800.00	124.49	850.36	(50.36)
	Total Membership	800.00	124.49	850.36	(50.36)
6600	OUTREACH				
6610	Pledge - BMF	6,000.00		6,000.00	-
6620	Special Offerings		393.00	2,177.00	(2,177.00)
6630	Christian Church Homes		220.00	1,178.50	(1,178.50)
6640	Heifer Project		1,890.00	2,193.00	(2,193.00)
6650	KY Council of Churches	100.00			100.00
6660	Local Outreach				-
6670	Human Concerns Funding	500.00		500.00	-
	Total Outreach	6,600.00	2,503.00	12,048.50	(5,448.50)
6700	STEWARDSHIP				
6710	Supplies & Expenses	200.00	94.08	346.44	(146.44)
	Total Stewardship	200.00	94.08	346.44	(146.44)
6800	WORSHIP				
6810	Bell Maintenance	150.00			150.00
6820	Candles & Flowers	600.00		31.39	568.61
6830	Choral Supplies	750.00	115.87	429.67	320.33
6840	Communion Supplies	450.00	11.82	223.42	226.58
6850	Organ Maintenance	1,200.00	264.03	640.03	559.97
6860	Piano Maintenance	200.00		225.00	(25.00)
6870	Printed Material	900.00		477.28	422.72
6880	Seasonal Decorations	250.00	17.80	67.80	182.20
6890	Miscellaneous	300.00	53.68	105.41	194.59
6895	Guest Musicians	400.00	200.00	300.00	100.00
	Total Worship	5,200.00	663.20	2,500.00	2,700.00
	Subtotal Expenses	139,736.68	15,181.15	119,673.72	20,062.96
7000	Non Budgeted Expenses				
7100	Program/Event Expense		208.00	837.00	(837.00)
7300	Capital Expenditures			1,655.70	(1,655.70)
7500	Uncategorized Expenses		66.85	224.55	(224.55)
	Total Non-Budgeted		274.85	2,717.25	(2,717.25)
	TOTAL EXPENSES	139,736.68	15,456.00	122,390.97	17,345.71
	NET INCOME(LOSS)		(2,887.89)	(129.58)	
	Bank Balance		01/01/2001	6,495.32	
	Bank Balance		12/31/2001	\$6,365.74	